

PRODUCT CATALOG

ROBAM

PRODUCT CATALOG

ROBAM

PRODUCT
CATALOG

ROBAM
WORLD CLASS LEADER
OF PREMIUM KITCHEN
APPLIANCES

SINCE 1979



CONTENTS

01

THE ROBAM
STORY

03

INTELLIGENT
MANUFACTURING

07

RECOGNIZED
BY THE WORLD

11

THE WAY
OF INNOVATION

15

THE OVERSEAS
LAYOUT

17

CORPORATE
CULTURE

19

SOCIAL
RESPONSIBILITY

22

RANGE
HOOD

42

HOB

64

OVEN

72

STEAM
OVEN

78

COMBI STEAM
OVEN

84

MICROWAVE
OVEN

90

DISHWASHER

THE ROBAM STORY

ROBAM is devoting to creat all the good aspirations of human beings for kitchen life, wishing more and more families enjoy the cooking happiness brought by ROBAM.

ROBAM Group, one of the world well known kitchen solutions provider. As one of Asia's top 500 brands, it has the highest reputation in Asia and take the largest share in the markets in many countries.

With around 42 years history, It has constantly set foot in the kitchen appliances industry and guided the industry development though continuous technical innovation. ROBAM Group owns six production bases, in the meanwhile global enterprises from Korea, France, Turkey etc....also provide customized products for ROBAM continuously, Fully reflects the globalization of manufacturing, technology and quality marks.

With the supporting of over 10,000 employees and global partners, the brand value of ROBAM Group is approaching to five billion dollars. Over 45 million global customers already benefited from ROBAM and is committed to achieve the goal of 50 million.



INTELLIGENT MANUFACTURING



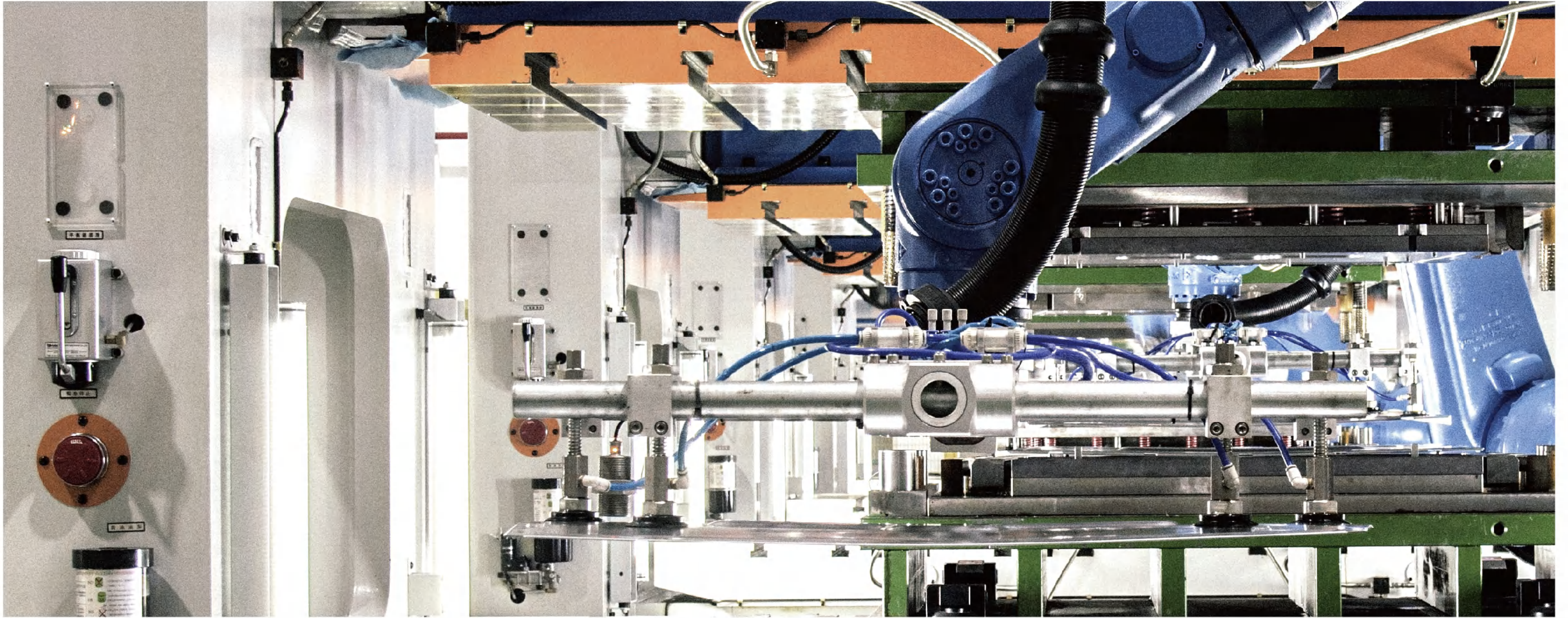

We designed a full set of system architecture of kitchen appliances intelligent manufacturing which is based on automation equipments, centered on MES and realizes the real-time interconnection between robots, production materials, equipments, AHV these factors by the Intelligent sensor technology and the industrial IOT network spreading all across the factory.

It can fully collect the manufacturing progress, on-site operation, quality inspection, equipment status, and further realize advanced sensor, management, testing, assembly, logistics as well as the high integration of intelligent technological equipments and production management software to set up the unmanned factory based on 5G technology.



RECOGNIAED BY THE WORLD

Since its inception, ROBAM has been building on its heritage of product innovation and creating kitchens that are stylish and clean.

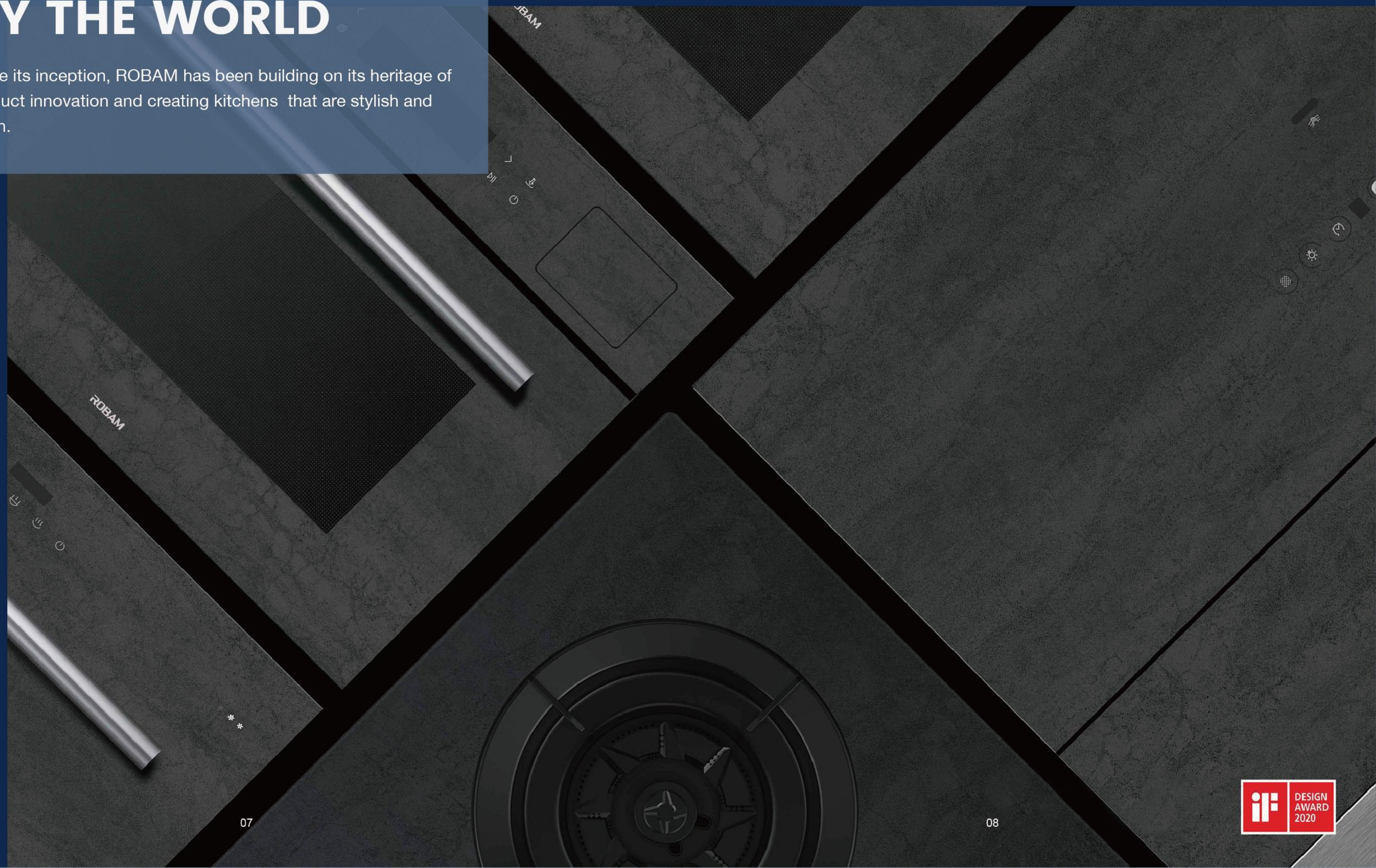



Awards

ROBAM is constantly inventing, designing and creating extraordinary products, and its sterling reputation as a leading kitchen expert is enforced by the brand's regular presence in international awards shows such as the iF Design Award, the Reddot Design Award and the CIDF.

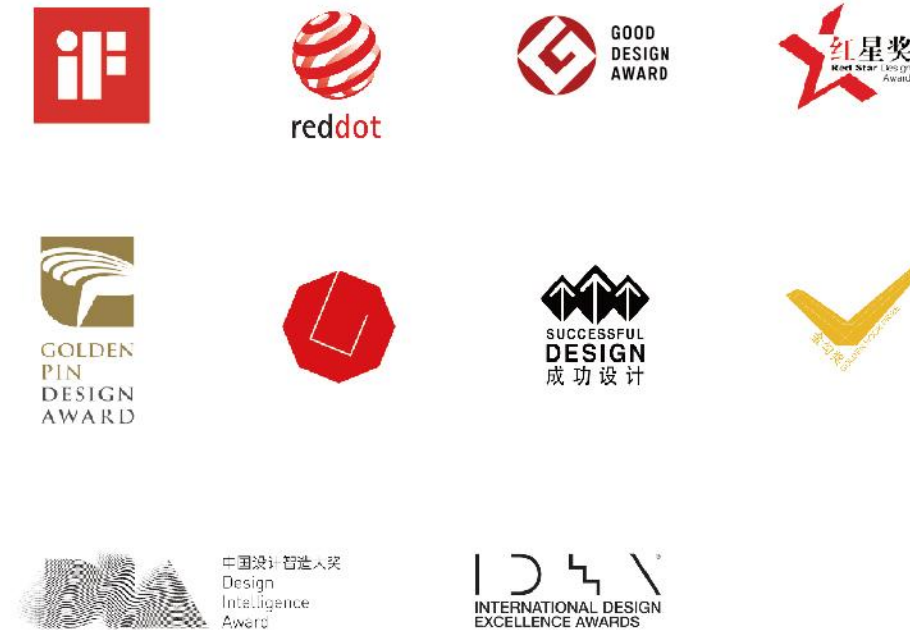

International Certification

1491
valid patents

234
world product certifications

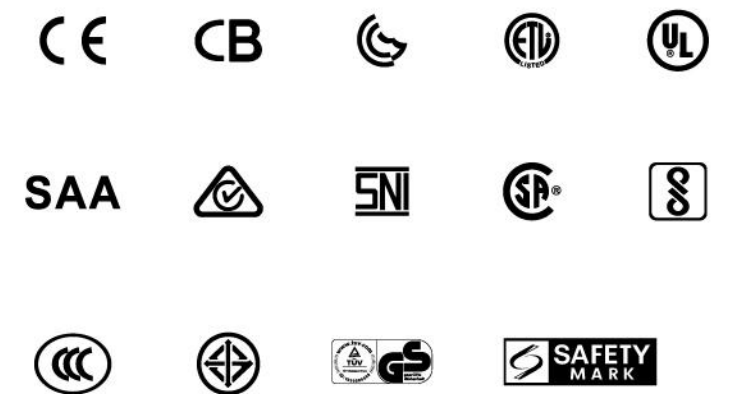

Quality Promise

To protect the rights and interests of consumer, all ROBAM products are underwrote by AIU (American International Underwriter) who is a subsidiary of the world class insurance group named AIG (American International Group) with a premium product liability insurance.

ROBAM not only enables consumers to enjoy easy cooking brought by advanced technology, but also provides multiple safeguards for your life.

THE WAY OF INNOVATION

Just as many other leading enterprises in the world, Robam is driven by the increasingly innovative technology to move forward.

The powerful suction system of the range hood originally created by Robam, defines the criteria of powerful suction from the all-round suck, powerful filtering, quick ventilation and energy efficiency.

It has led the revolution of suction in the industry for many times.

The powerful flame, 3D flame and the concentrated powerful fire technology has greatly improved the heat efficiency.

The professional double temperature control oven allows two temperatures to coexist in one cavity and achieves precise 1°C baking.

The omnidirectional heating tubes makes the baking faster and more uniform.

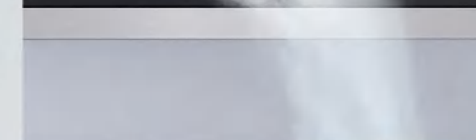



ROBAM intelligent three-core steam oven can eliminates condensed water with the u-shape top heating tubes, so that to ensure the steaming taste of food after opening the door.



The multifunctional combi steam oven combines both steaming and baking, saving more kitchen space but bring better taste.



The inverter technology makes your life easier and brings you more efficient and more intelligent cooking life.



The dishwasher imported from France specializes in the large capacity and powerful washing effect.

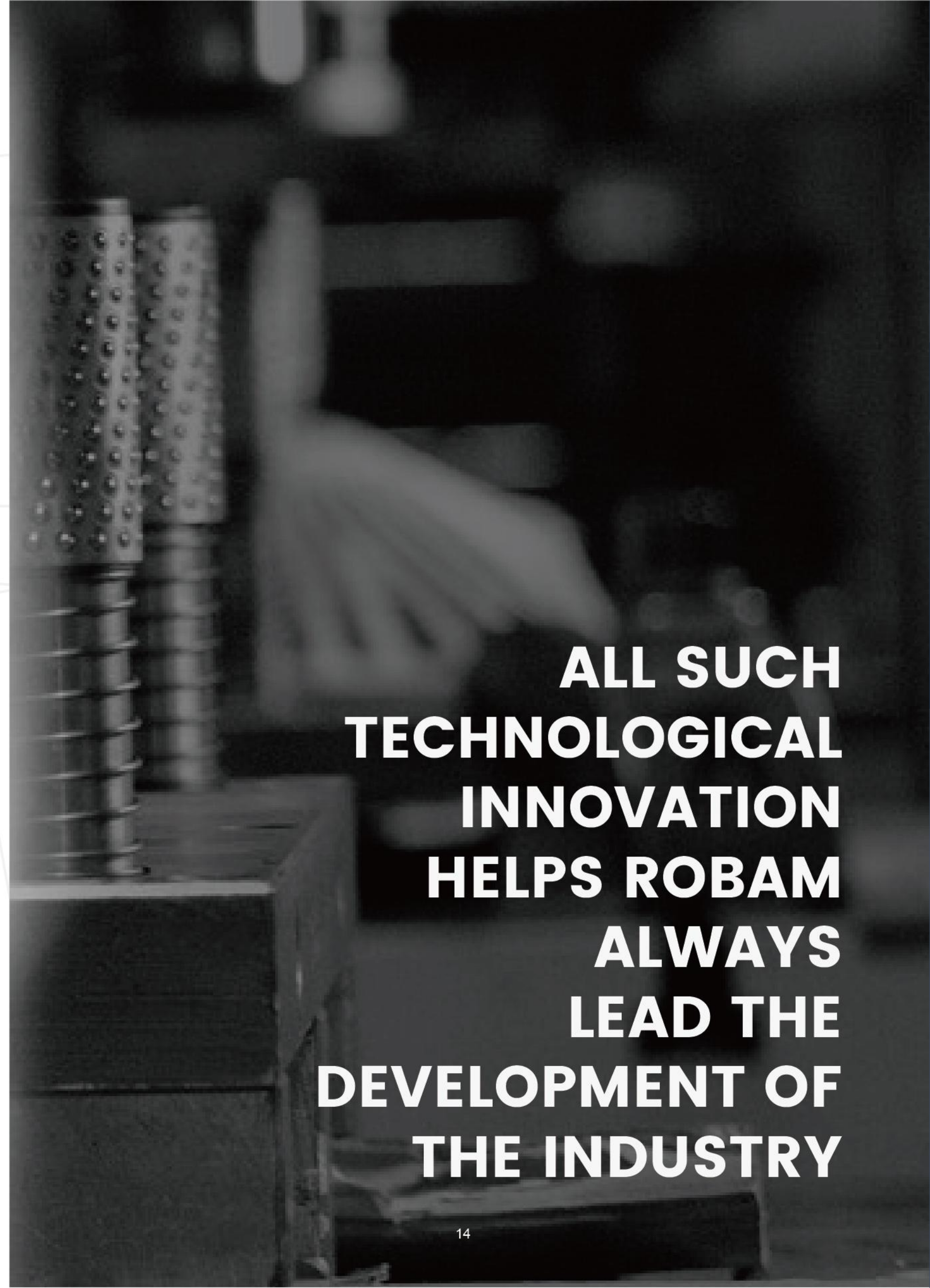

**ALL SUCH
TECHNOLOGICAL
INNOVATION
HELPS ROBAM
ALWAYS
LEAD THE
DEVELOPMENT OF
THE INDUSTRY**

THE OVERSEAS LAYOUT

At present, ROBAM has dozens of brand shops and more than 400 retail terminals overseas.

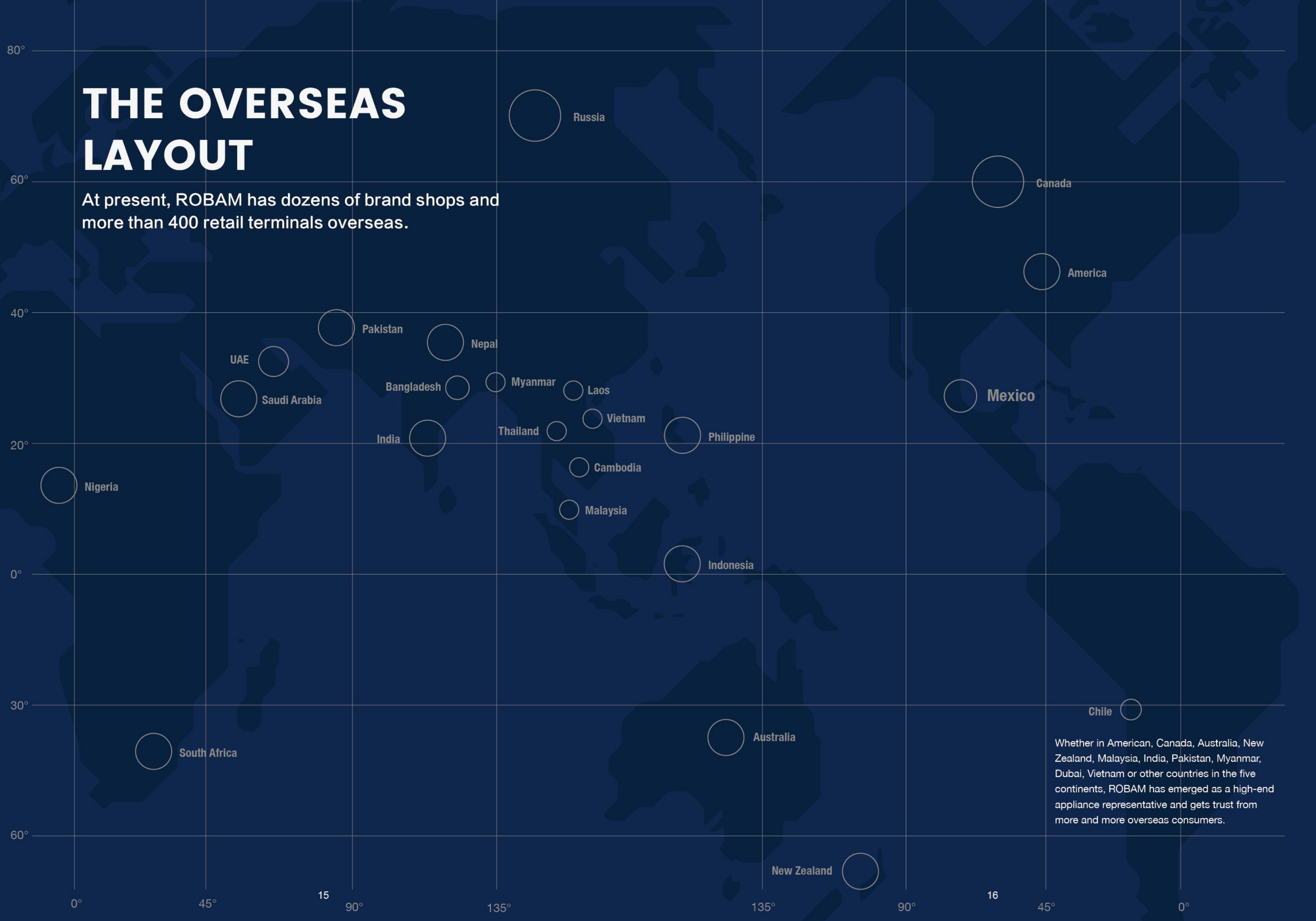

Whether in American, Canada, Australia, New Zealand, Malaysia, India, Pakistan, Myanmar, Dubai, Vietnam or other countries in the five continents, ROBAM has emerged as a high-end appliance representative and gets trust from more and more overseas consumers.

CORPORATE CULTURE

We'll never forget why you started and execute it by heart.

Create all beautiful aspirations for the cooking life of human beings.





SOCIAL RESPONSIBILITY

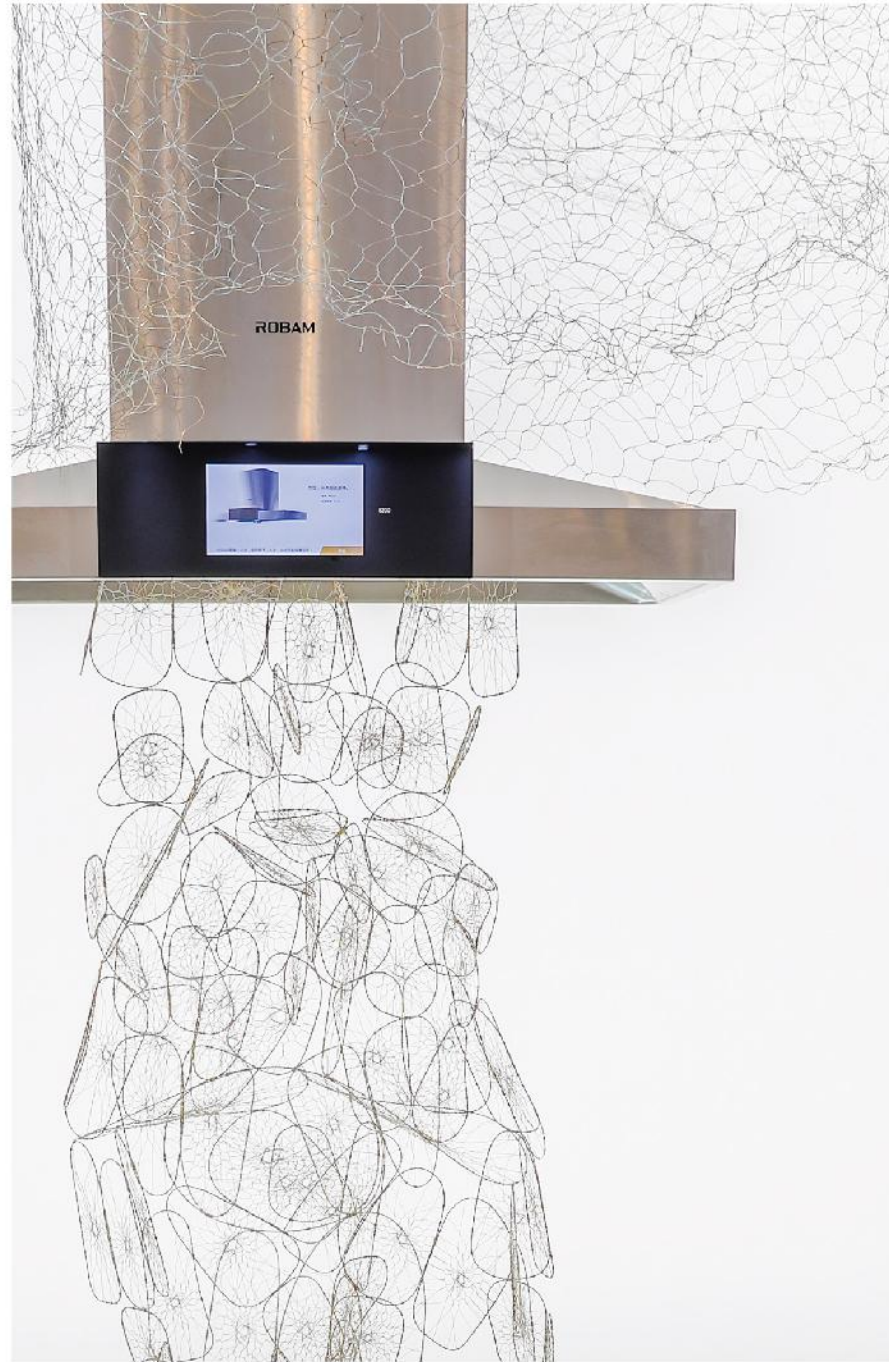

THE LAKE Public Welfare Project

In 2016, Robam coordinated with The Nature Conservancy, Rong Design Library, PINWU Design Studio launches together the project of protecting the source of drinking water of Qingshan village-The Lake.

The design concept of his project starts with kitchen life, coordinated with the native villagers and interprets the beauty of combination of traditional culture and modern life style with various handicraft works.

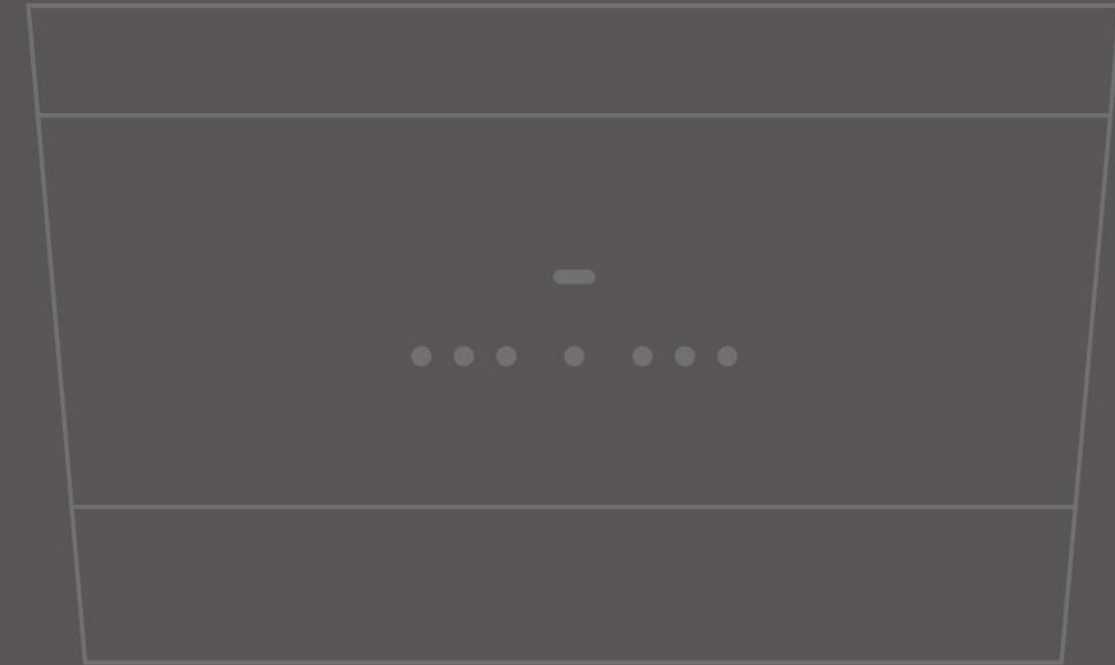

RANGE HOOD



Anti-epidemic Public Benefit

During the pandemic covid-19 period in 2020, every distributor of Robam appliances in the world carried out public benefit activities actively and make their own contribution for the anti-epidemic career by caring for the consumers.

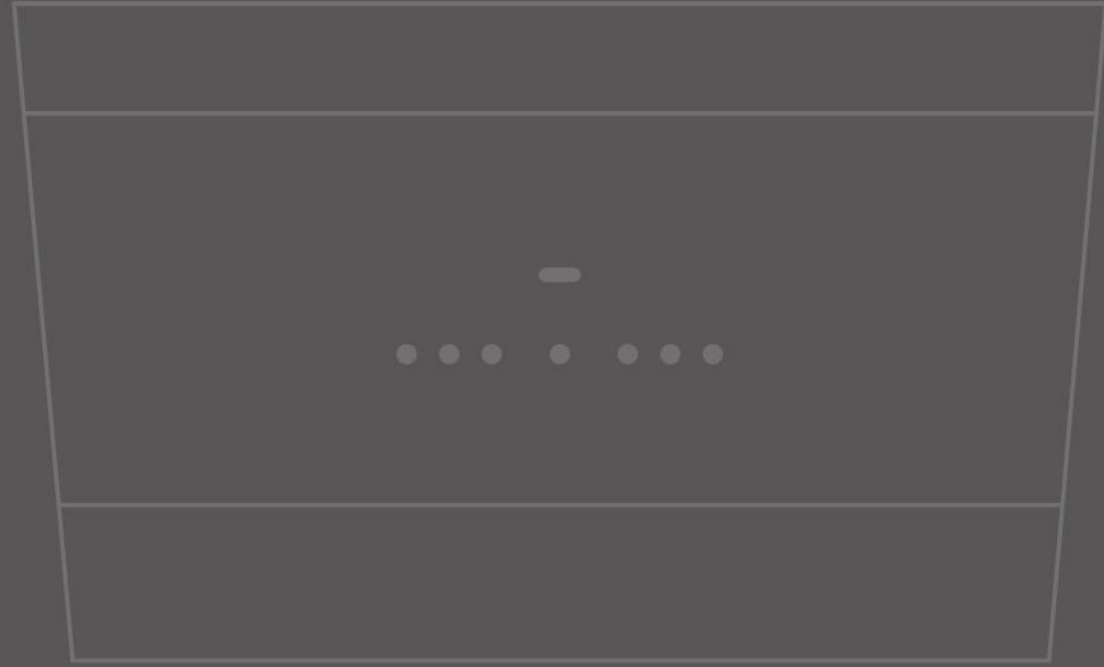

RANGE HOOD



1 Double static pressure, greater suction power.

800pa-1000pa immediate exhaust, double static pressure, highly effective smoke gathering canopy design.
Recommended: A837/A830/A831/A832/A675S



2 Brushless DC motor

BMC integrated reinforced structure with all-round heat insulation technology. Full pressure efficiency of more than 30%. Quiet with noise as low as 42dB.
Recommended: A837/A830/A832/A675S



3 No need to disassemble for cleaning

The fish-scale liquid separation process is used to prevent the oil and the grease separation can reach up to 98%. The effective separation of fume makes the inner cavity clean as new.
Recommended: A837/A815/A670/A675S



4 Strong core equipped with 360° tornado suction

The turbine was designed of golden ratio and it is placed vertically to ensure to intake fume on both sides; the BLDC inverter motor can provide enough power, so as to quickly prevent fume from spreading.
Recommended: A900/A837/A817

5 An expert in caring family by wide absorption of fume

Wide screen covering all areas and preventing leakage of fume.
Recommended: A675S/A670/A672



6 Intelligent sensor

Liberating your hands as well as a protection of range hood, maintaining clean hands.
Recommended: A670/A675S/A672





CXW-220-A900



Product Size:	600x645x900mm (WxDxH)
Motor Power:	220W
Maximum Air Flow Rate:	1080m ³ /h
Max Static Pressure:	350Pa
Noise:	≤ 68dB(A)

Features

- 19m³/min ultra-high suction power, provide a clean kitchen;
- Perfectly combines technology with aesthetics, recovers the clean charm of kitchen from inside out;
- Control interface, far infrared real-time monitoring, free switch of wind power at different levels;
- Made of pure stainless steel, fume is easily exhaust out;
- 360° universal strip light creates all-dimensional shadowless cooking view;

Installation

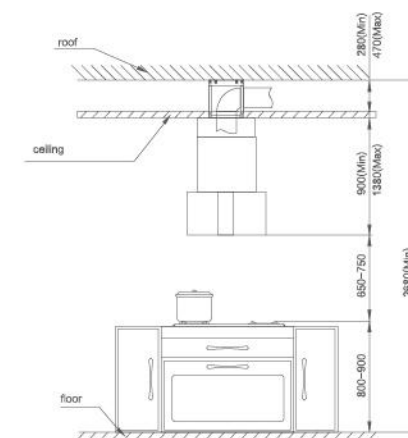

CXW-260-A835S



Product Size:	895x410x668mm (WxDxH)
Motor Power:	260W
Maximum Air Flow Rate:	1500m ³ /h
Max Static Pressure:	1000Pa
Noise:	≤ 50dB(A)

Features

- Super power, up to 1000Pa Static pressure;
- Super airflow rate, exhaust the fumes in seconds;
- AI smart gesture control, by waving your hand;
- 50d(B)A Low noise, be more quiet;
- BLDC inverter motor;
- Double cavity for collecting fumes;
- Separate control of two sides;

Certificate

CB / RCM / SIRIM / ETL / HVI

Installation

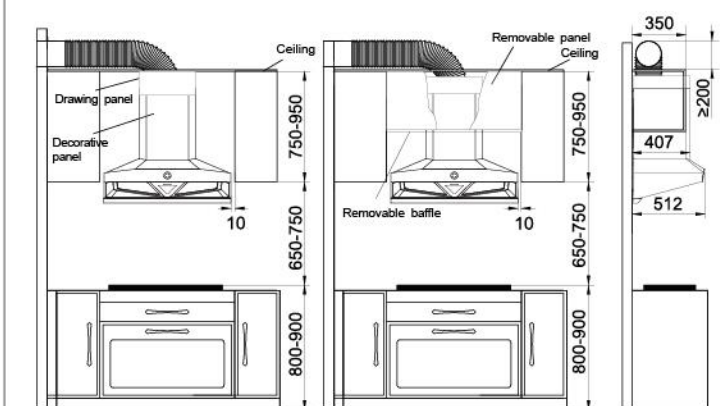

CXW-200-A837



Product Size:	895x504x684mm (WxDxH)
Motor Power:	200W
Maximum Air Flow Rate:	1200m ³ /h
Max Static Pressure:	800Pa
Noise:	≤ 53dB(A)

Features

- 800Pa Max static pressure;
- BLDC inverter motor;
- Turbo function for stir-fry;
- FOC Intelligent quick speed control system;
- Non-disassembly and wash free;

Certificate

RCM / SIRIM / cETLus / FCC / CEC / IC

Installation

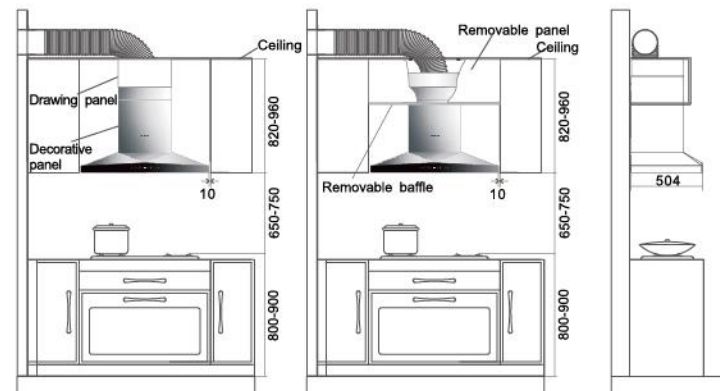

CXW-200-A829



Product Size:	895x504x684mm (WxDxH)
Motor Power:	200W
Maximum Air Flow Rate:	1200m ³ /h
Max Static Pressure:	430Pa
Noise:	≤ 57dB(A)

Features

- Diamond cutting craft;
- Deep Cavity;
- Nano oil-free coating;
- Turbo function for stir-fry;
- Timer function;
- Filter cleaning reminder;
- Premium Grade 304 Stainless Steel filter;
- Non-disassembly and wash free;
- One-minute turn off delay;

Certificate

SIRIM / RCM / ECAS / RoHS / Saber / LOA / CoC / cETLus / FCC / CEC / IC

Installation

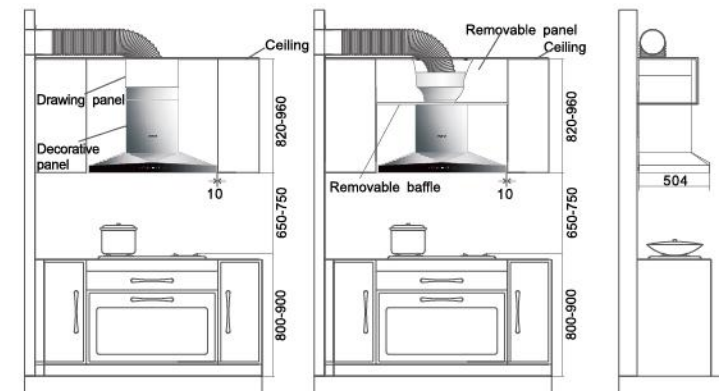

CXW-220-A828



Product Size:	895x504x640mm (WxDxH)
Motor Power:	220W
Maximum Air Flow Rate:	1200m ³ /h
Max Static Pressure:	420Pa
Noise:	≤ 56dB(A)

Features

- 4.3-inch HD Touch Screen;
- Smart recipe display;
- Air detection and purify;
- Filter cleaning reminder;
- Turbo function for stir-fry;
- Premium Grade 304 Stainless Steel filter;
- Non-disassembly and wash free;
- One-minute turn off delay;

Certificate

RCM / SIRIM / LOA / CoC

Installation

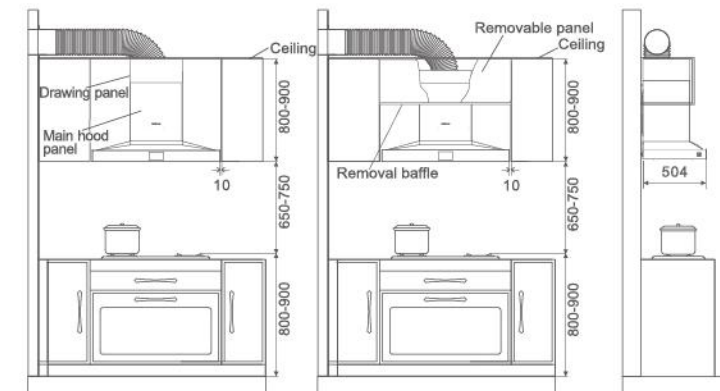

CXW-200-A825



Product Size:	895x504x684mm (WxDxH)
Motor Power:	200W
Maximum Air Flow Rate:	1200m ³ /h
Max Static Pressure:	430Pa
Noise:	≤ 57dB(A)

Features

- Deep Cavity;
- Nano oil-free coating;
- Premium Grade 304 Stainless Steel filter;
- Non-disassembly and wash free;
- One-minute turn off delay;

Certificate

SIRIM / RCM / ECAS / RoHS / Saber / LOA / CoC

Installation

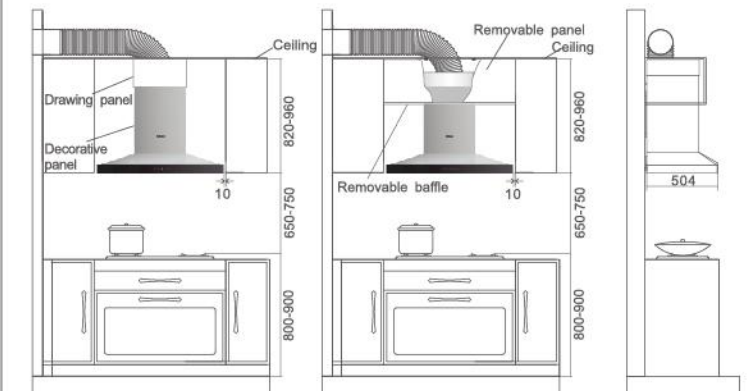

CXW-200-A830



Product Size:	595x510x560mm (WxDxH)
Motor Power:	200W
Maximum Air Flow Rate:	1020m ³ /h
Max Static Pressure:	800Pa
Noise:	≤ 56dB(A)

Features

- 800Pa Max static pressure;
- BLDC inverter motor;
- Super carbon filter;
- Slider control;
- Could be embedded to the cabinet;

Certificate

RCM / SIRIM / SONCAP / Saber

Installation

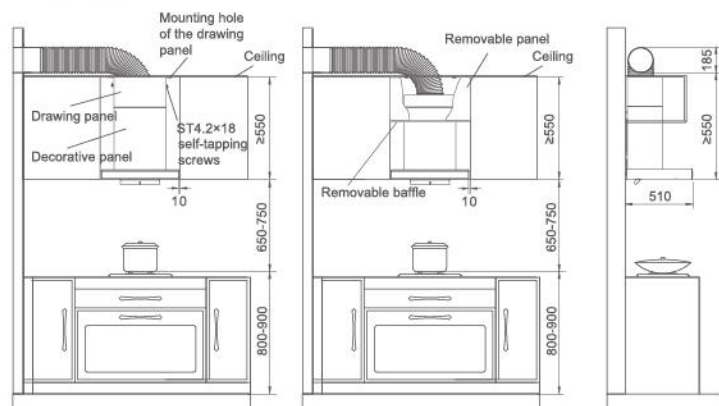

CXW-220-A817



Product Size:	895x500x537mm (WxDxH)
Motor Power:	220W
Maximum Air Flow Rate:	1140m ³ /h
Max Static Pressure:	340Pa
Noise:	≤ 58dB(A)

Features

- A++ easy-clean filter;
- Turbo function for stir-fry;
- Head injury protection;
- Non-disassembly and wash free;
- One-minute turn off delay;

Certificate

RCM / SIRIM / ECAS / RoHS / LOA / CoC / cETLus / FCC / CEC / IC

Installation

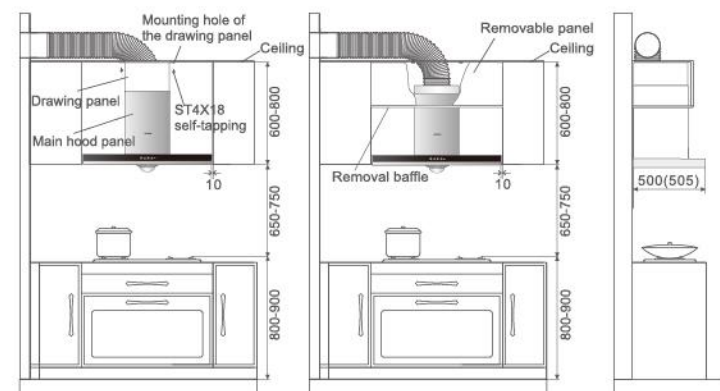

CXW-200-A851



Product Size:	895x505x537mm (WxDxH)
Motor Power:	200W
Maximum Air Flow Rate:	1080m ³ /h
Max Static Pressure:	360Pa
Noise:	≤ 55dB(A)

Features

- Double core system 3.0;
- 360Pa big static pressure, rapid smoke extraction;
- A++ mesh to achieve more than 92% oil separation;
- Oil mesh with 24 oil -way tubes, the oil slides quickly without leakage;
- A new generation of no-washing internal cavity technology help free from removing and washing;
- One minute delay shutdown;

Certificate

CB / RCM

Installation

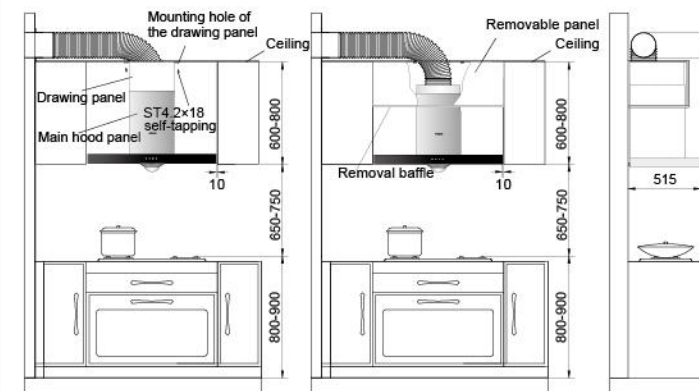

CXW-220-A815



Product Size:	895x505x537mm (WxDxH)
Motor Power:	220W
Maximum Air Flow Rate:	1140m ³ /h
Max Static Pressure:	340Pa
Noise:	≤ 58dB(A)

Features

- Turbo function for stir-fry;
- Tiger* environmentally friendly coating body;
- Non-disassembly and wash free;
- One-minute turn off delay;

Certificate

RCM / SIRIM / ECAS / RoHS / LOA / CoC

Installation

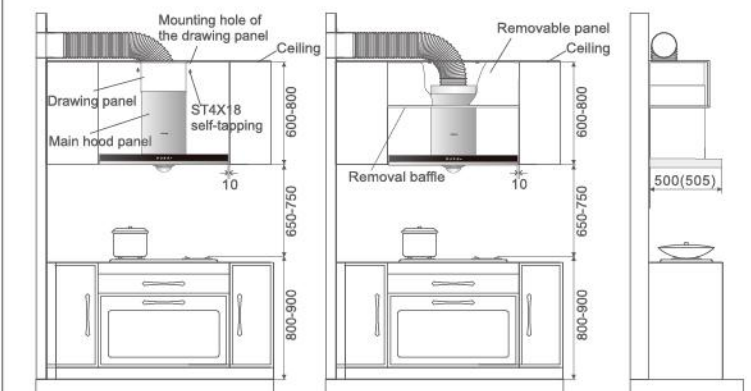

CXW-200-A816



Product Size:	895x480x528mm (WxDxH)
Motor Power:	200W
Maximum Air Flow Rate:	1020m ³ /h
Max Static Pressure:	310Pa
Noise:	≤ 58.5dB(A)

Features

- 360° tornado powerful suction;
- A++ easy-clean filter;
- Non-disassembly and wash free;

Certificate

SIRIM / ECAS / RoHS / RCM

Installation

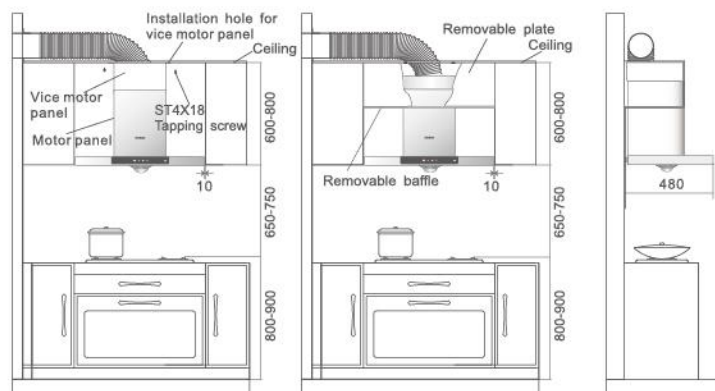

CXW-320-A819 (600/900)



Product Size:	600(900)x485x447mm (WxDxH)
Motor Power:	320W
Maximum Air Flow Rate:	1000m ³ /h
Max Static Pressure:	490Pa
Noise:	≤ 68dB (A)

Features

- Super motor brings efficient suction and forcibly takes away fume;
- Four gears of air force allow adjustment at will;
- A higher gear for stir-fry and a lower gear for soup cooking to keep kitchen clean and fresh;
- Three layers of aluminum mesh are overlapped to intercept and separate oil and smoke fast;
- Disassemble snap joint allows taking-out of the oil screen by a gentle press;

Installation

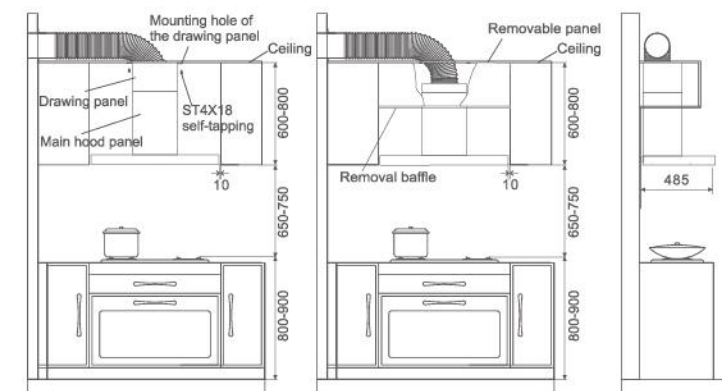

CXW-200-A605



Product Size:	595x440x529mm (WxDxH)
Motor Power:	200W
Maximum Air Flow Rate:	1020m ³ /h
Max Static Pressure:	310Pa
Noise:	≤ 58dB(A)

Features

- 430 stainless steel body;
- Fingerprint proof coating;
- Non-disassembly and wash free;
- One-minute turn off delay;

Certificate

RCM / LOA / CoC / ECAS / RoHS / LOA / CoC

Installation

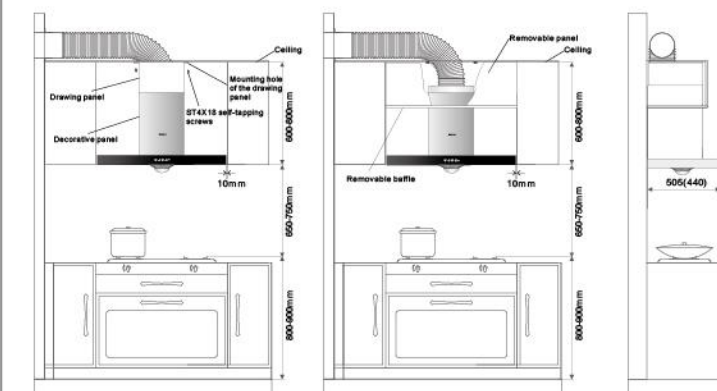

CXW-220-A807



Product Size:	595x440x529mm (WxDxH)
Motor Power:	220W
Maximum Air Flow Rate:	1110m ³ /h
Max Static Pressure:	330Pa
Noise:	≤ 58dB (A)

Features

- 360° tomadic air suction, 320Pa air pressure, faster extraction & exhaustion;
- Patented A++ strainer filters heavy oil molecules, to ensure interior cavity is clean and operation is stable;
- Quick oil cleaning technology, self-cleaning of lotus leaf effect, non-adhesive oil stains;
- Integrated smoke collecting cavity is made of painting;
- Humanized fastener, removable strainer, simple cleaning;

Installation

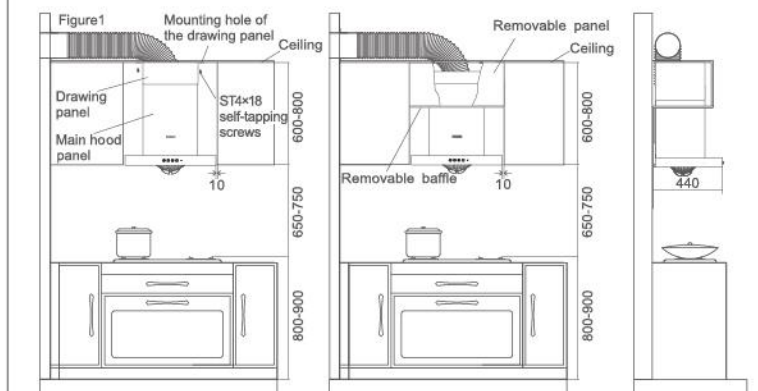

CXW-200-A812



Product Size:	895x520x545mm (WxDxH)
Motor Power:	200W
Maximum Air Flow Rate:	1020m ³ /h
Max Static Pressure:	310Pa
Noise:	≤ 58dB(A)

Features

- Elegant design;
- Gas sensor & heat sensor;
- Ducted and recirculated;
- Non-disassembly and wash free;
- One-minute turn off delay;

Certificate

SIRIM / RCM / LOA / CoC

Installation

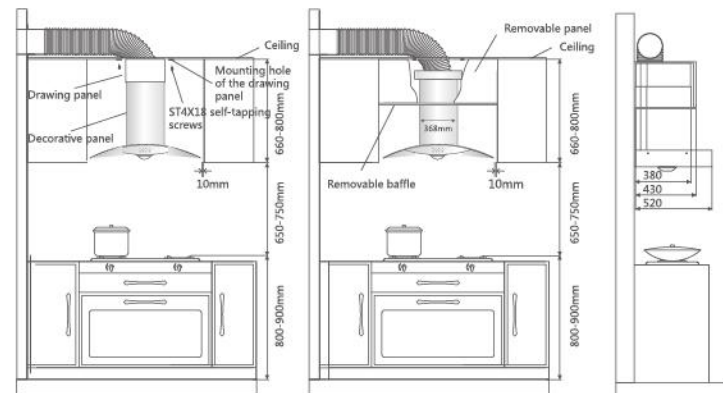

CXW-200-A608



Product Size:	600x520x500mm (WxDxH)
Motor Power:	200W
Maximum Air Flow Rate:	1020m ³ /h
Max Static Pressure:	310Pa
Noise:	≤ 58dB(A)

Features

- Small size of 600mm;
- Lovely "smile face" design;
- Gas sensor & heat sensor;
- Optional carbon filter;
- Non-disassembly and wash free;
- one-minute delay off function;

Certificate

RCM / SIRIM / ECAS / RoHS / LOA / CoC

Installation

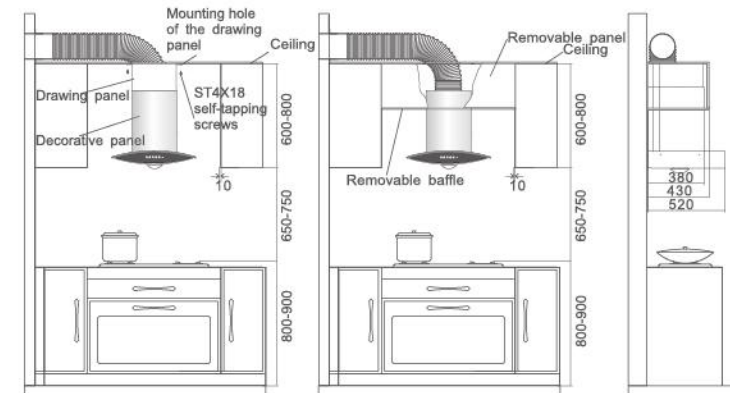

CXW-260-A675S



Product Size:	895x410x668mm (WxDxH)
Motor Power:	260W
Maximum Air Flow Rate:	1500m ³ /h
Max Static Pressure:	1000Pa
Noise:	≤ 50dB(A)

Features

Collect fumes in all directions, Improve your cooking experience;
 1500m³/h Airflow rate, exhaust the fumes in seconds;
 AI smart gesture control, by waving your hand;
 Breathing ring LED light, touch control fan speed;
 Special A++ oil filter, easy to clean;
 Short-range of negative pressure, fumes can not run away;
 Completely new system 8.0, with BLDC inverter motor;

Certificate

RCM / SIRIM

Installation

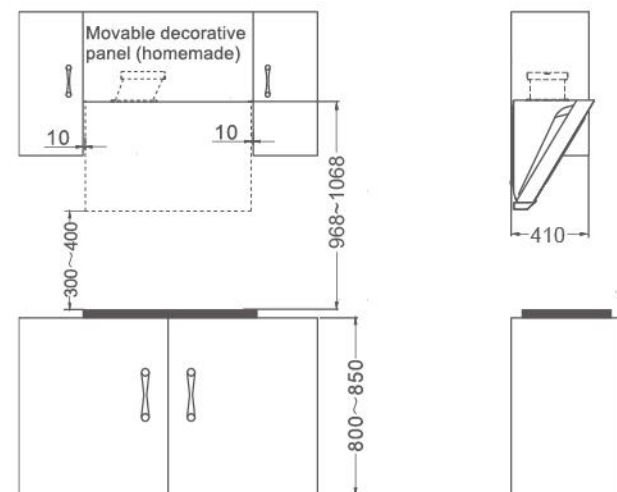

CXW-260-A672



Product Size:	29-7/8 x17-13/16 x17-3/4" (WxDxH)
Motor Power:	260W
Max Static Pressure:	450Pa
Noise:	≤ 67dB(A)

*SPECIALLY FOR NORTH AMERICAN KITCHENS 🇺🇸 🇨🇦 🇩🇪

Features

AI smart gesture control, by waving your hand;
 105° Large screen to exhaust out from all-around directions;
 Turbo function for stir-fry;
 Oil cup with large capacity;
 Non-disassembly and wash free;

Certificate

cETLus / FCC / CEC / IC

Installation

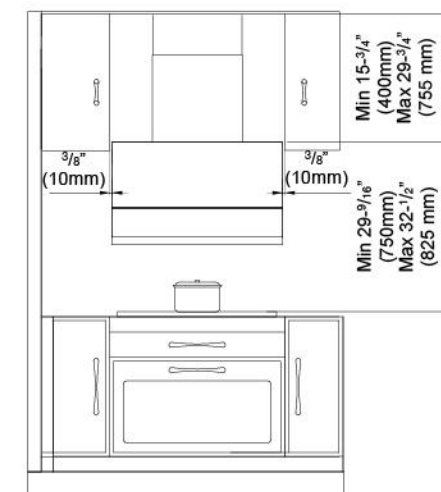

CXW-260-A671



Product Size:	29-7/8 x17-13/16 x17-3/4" (WxDxH)
Motor Power:	260W
Max Static Pressure:	450Pa
Noise:	≤ 67dB(A)

*SPECIALLY FOR NORTH AMERICAN KITCHENS 🇺🇸 🇨🇦 🇩🇪

Features

Waving sensor;
 Large screen to suck from all-around directions;
 Turbo function for stir-fry;
 Easily removable filter;
 Oil cup with large capacity;
 Non-disassembly and wash free;

Certificate

cETLus / FCC / CEC / IC

Installation

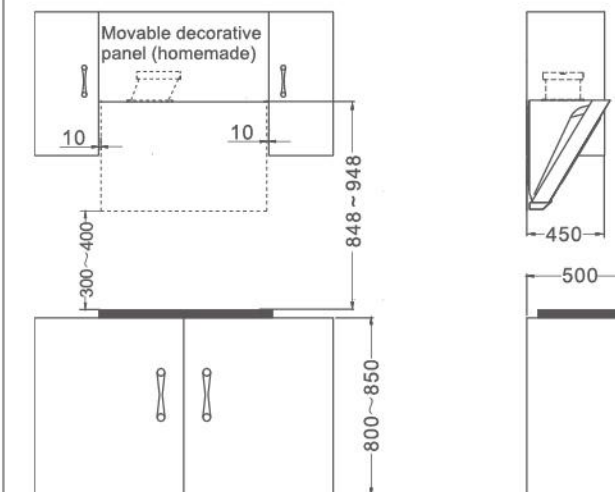

CXW-220-A670



Product Size:	895x399x548mm (WxDxH)
Motor Power:	220W
Maximum Air Flow Rate:	1200m ³ /h
Max Static Pressure:	430Pa
Noise:	≤ 57dB(A)

Features

Waving sensor;
 Large screen to suck from all-around directions;
 Turbo function for stir-fry;
 Easily removable filter;
 Oil cup with large capacity;
 Non-disassembly and wash free;

Certificate

RCM / SIRIM / ECAS / RoHS / LOA /
 CoC / cETLus / FCC / CEC / IC

Installation

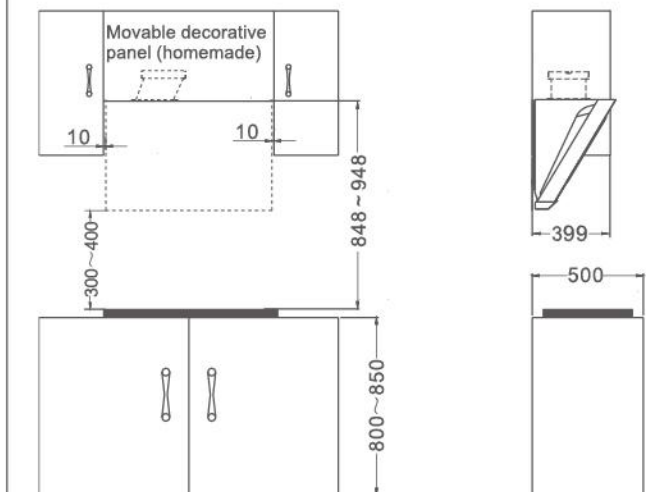

CXW-260-A676



Product Size:	895x399x551mm (WxDxH)
Motor Power:	260W
Maximum Air Flow Rate:	1260m ³ /h
Max Static Pressure:	420Pa
Noise:	≤ 52dB(A)

Features

- Wave hands 2.0;
- A++ oil-filter screen;
- Glass panel, easy to clean;
- One button quick-fry function to rise to the largest wind volume;

Certificate

CB / RCM

Installation

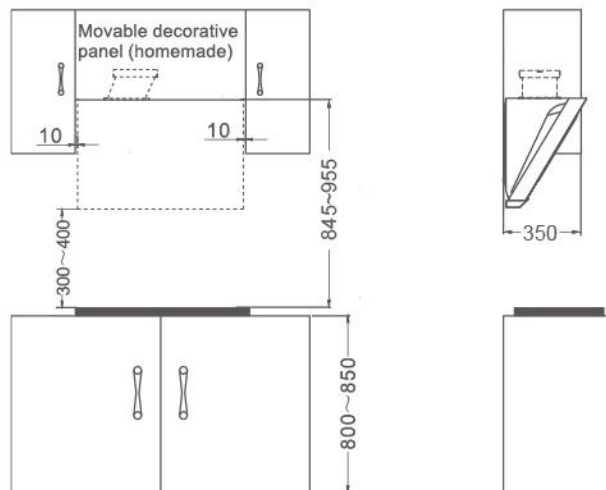

CXW-218-A651



Product Size:	700x358x500mm (WxDxH)
Motor Power:	218W
Maximum Air Flow Rate:	1020m ³ /h
Max Static Pressure:	400Pa
Noise:	≤ 53dB(A)

Features

- 1020m³/h large suction power to eliminate fumes, breathe freely, enjoy healthy cooking;
- 700mm easy matching size, no installation trouble in different kitchens;
- Innovative design of side suction appearance, more exquisite and beautiful than common range hoods;
- Humanized design details, easy to clean and take care of the range hood;

Installation

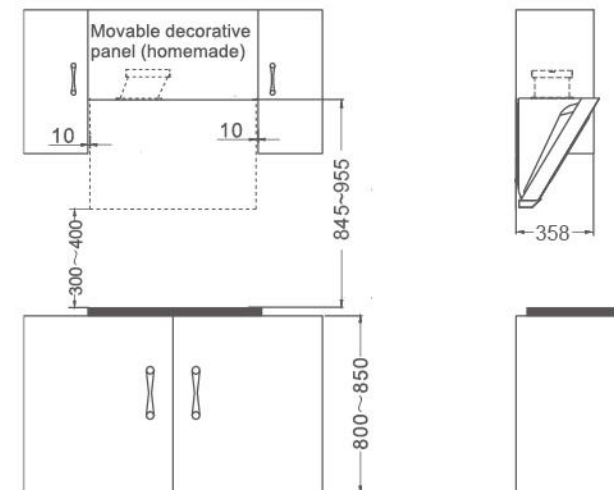

CXW-200-A606



Product Size:	795x354x579mm (WxDxH)
Motor Power:	200W
Maximum Air Flow Rate:	1110m ³ /h
Max Static Pressure:	370Pa
Noise:	≤ 57.5dB(A)

Features

- 800mm customization size;
- Supreme suction pressure;
- Easily removable filter;
- Oil tray with large capacity;
- Non-disassembly and wash free;
- One-minute turn off delay;

Certificate

ECAS / RoHS / RCM / Saber / LOA / CoC

Installation

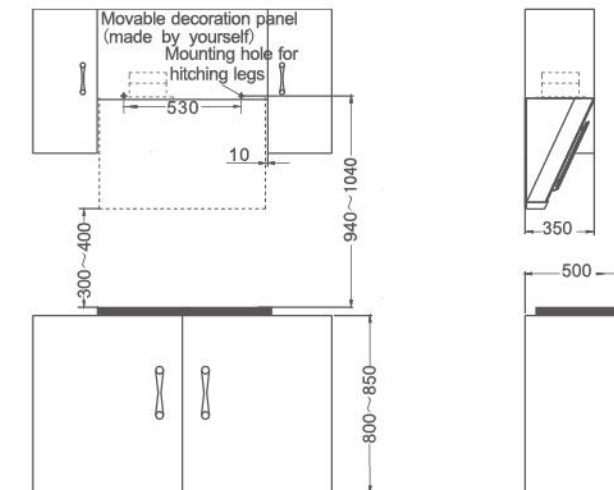

CXW-220-A610



Product Size:	595x350x569mm (WxDxH)
Motor Power:	220W
Maximum Air Flow Rate:	1020m ³ /h
Max Static Pressure:	400Pa
Noise:	≤ 58dB(A)

Features

- Modern design;
- 600mm Small Size;
- Supreme suction air pressure;
- Easily removable filter;
- Oil tray with large capacity;
- Non-disassembly and wash free;
- One-minute turn off delay;

Certificate

RCM / SIRIM / ECAS / RoHS

Installation

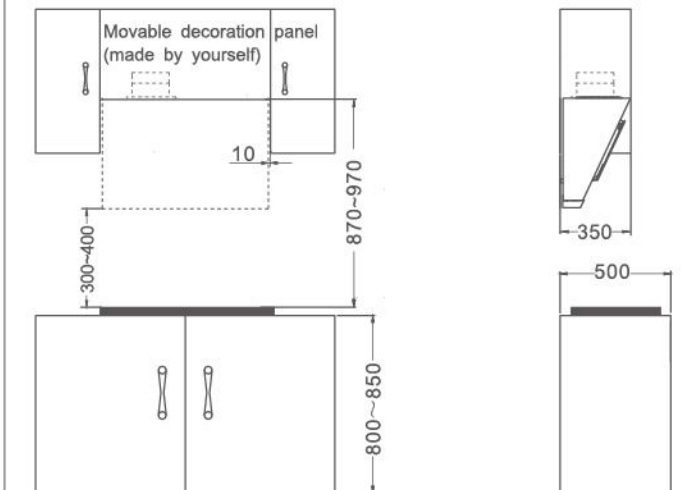

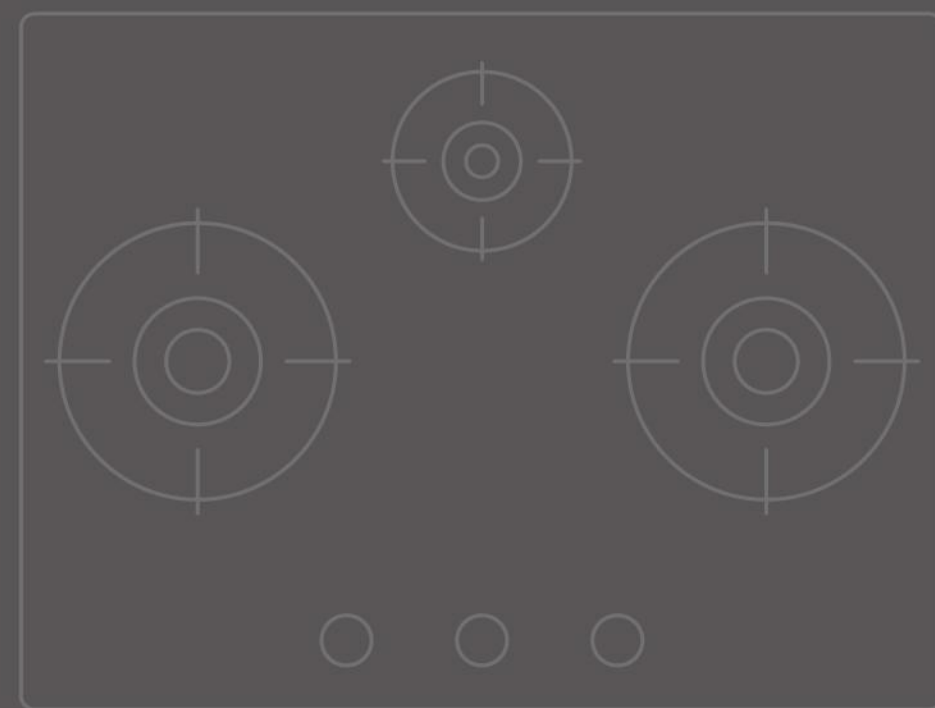

HOB

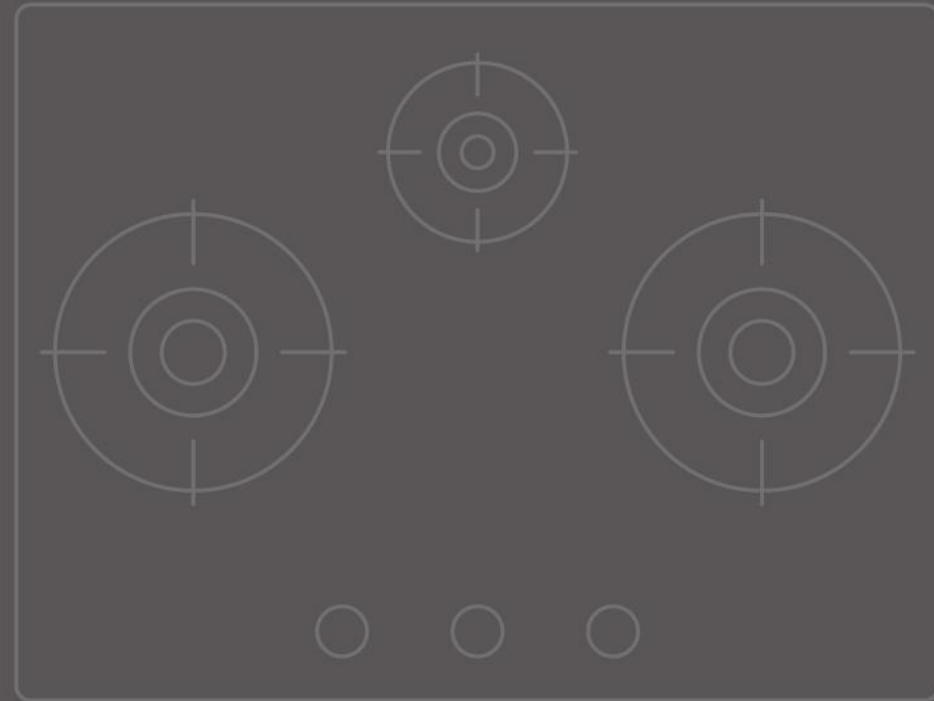

HOB



Defendi

- ① Original Italy burner, durable pure copper burner.
- ② Precise firepower, extraordinary delicacy.
- ③ Enduring, vigorous firepower.

Recommend: B312 / B410 / B510 / G515

3D Flame

- ① All-around even burning, cooks thoroughly.
- ② Powerful burning, cooks quickly.
- ③ Steady burning, cooks with good taste.



Recommend: B928 / B397 / B482





JZ(Y/T)-B312



Product Size:	900x500mm
Installation Size:	820x450mm
Heat Flow (MJ/h):	18x2, 6.3x1  
Flame Failure Device:	Yes

Features

- Italian made Defendi* Dual brass burner;
- 18MJ/h Supreme firepower;
- Upper air-intake;
- Flame failure protection;
- Disassemble burner;
- Easy cleaning surface;

Certificate

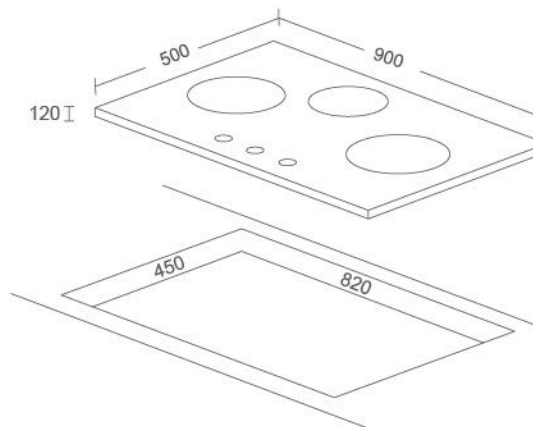

IAPMO

Installation



JZ(Y/T)-B310



Product Size:	900x520mm
Installation Size:	827x485mm
Heat Flow (MJ/h):	18x2, 6x1  
Flame Failure Device:	Yes

Features

- Italian made Defendi* Dual brass burner;
- 18MJ/h Supreme firepower;
- Upper air-intake;
- Flame failure protection;
- Disassemble burner;
- Easy cleaning and tempered glass surface;

Certificate

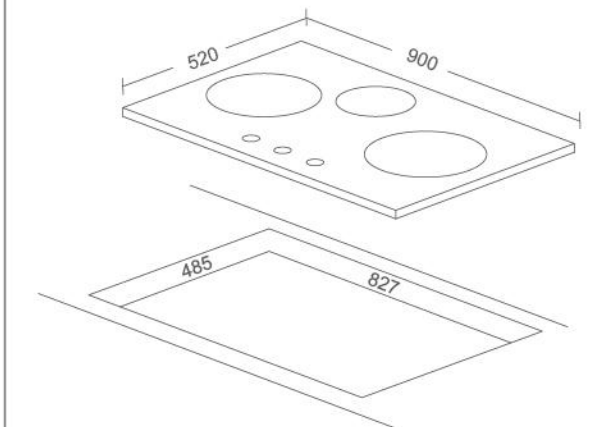

IAPMO

Installation



JZ(Y/T)-G311



Product Size:	860x510mm
Installation Size:	827x485mm
Heat Flow (MJ/h):	18x2, 6x1  
Flame Failure Device:	Yes

Features

Italian made Defendi* Dual brass burner;
 18MJ/h Supreme firepower;
 Upper air-intake;
 Flame failure protection;
 Disassemble burner;
 Premium Grade 304 Stainless Steel surface;

Certificate

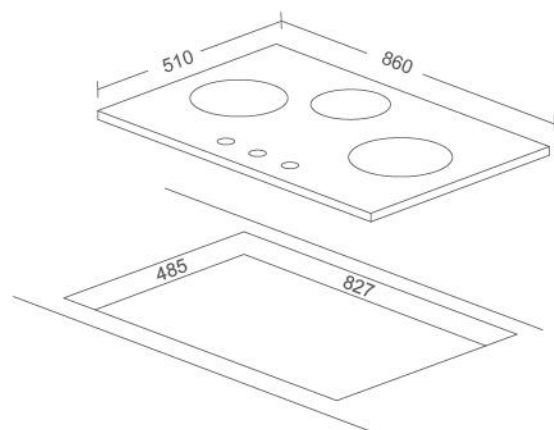

IAPMO

Installation



JZ(Y/T)-B410



Product Size:	605x520mm
Installation Size:	564x483mm
Heat Flow (MJ/h):	18x1, 10.5x1, 6x1, 3.6x1  
Flame Failure Device:	Yes

Features

Italian made Defendi* Dual brass burner;
 18MJ/h Supreme firepower;
 Upper air-intake;
 Flame failure protection;
 Disassemble burner;
 Easy cleaning and tempered glass surface;

Certificate

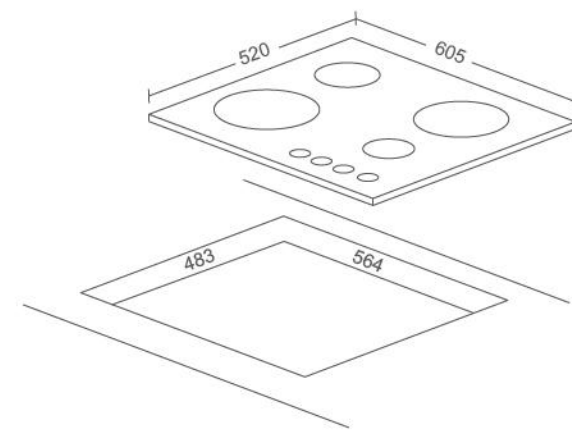

IAPMO

Installation



JZ(Y/T)-G411



Product Size:	600x510mm
Installation Size:	564x483mm
Heat Flow (MJ/h):	18x1, 10.5x1, 6x1, 3.6x1  
Flame Failure Device:	Yes

Features

Italian made Defendi* Dual brass burner;
 18MJ/h Supreme firepower;
 Upper air-intake;
 Flame failure protection;
 Disassemble burner;
 Premium Grade 304 Stainless Steel surface;

Certificate

IAPMO

Installation

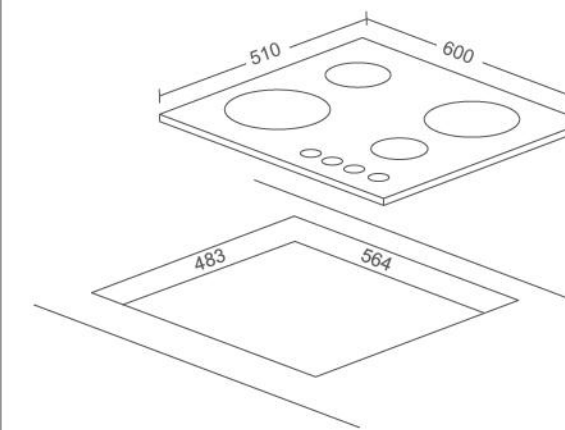

JZ(Y/T)-G413



Product Size:	30x21x2 ³ / ₅ "
Installation Size:	28x19"
Heat Flow (BTU):	20000, 13000, 9500, 5000
Flame Failure Device:	Yes

*SPECIALLY FOR NORTH AMERICAN KITCHENS   

Features

Italian made, Defendi* Dual brass burner;
 20000BTU Supreme firepower;
 Upper air-intake;
 Flame Failure Protection;
 Disassemble burner;
 Premium grade 304# stainless steel surface;

Certificate

cETLus / cCSAus / FCC / CEC / IC

Installation

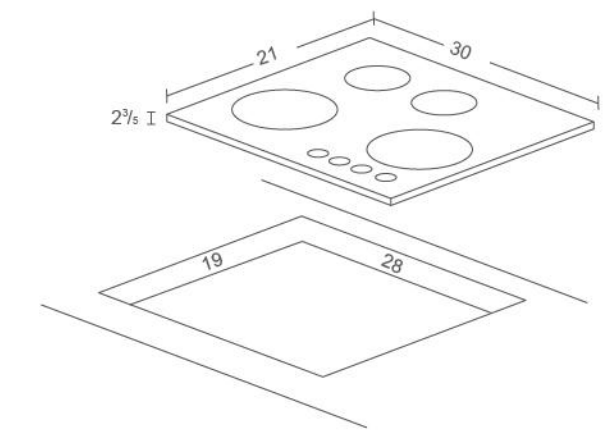

JZ(Y/T)-B510



Product Size:	900x510mm
Installation Size:	840x480mm
Heat Flow (MJ/h):	18x1, 10.5x1, 6x2, 3.6x1 
Flame Failure Device:	Yes

Features

- Italian made Defendi* Dual brass burner;
- 18MJ/h Supreme firepower;
- Upper air-intake;
- Flame failure protection;
- Disassemble burner;
- Easy cleaning surface;
- 8mm tempered glass;

Certificate

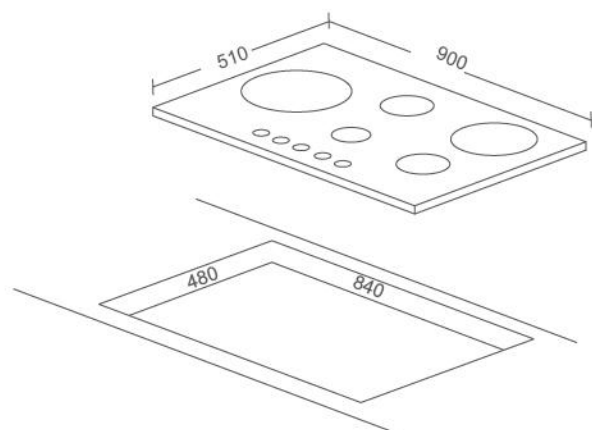

IAPMO

Installation



JZ(Y/T)-G511



Product Size:	860x510mm
Installation Size:	827x485mm 
Heat Flow (MJ/h):	18x1, 10.5x1, 6x2, 3.6x1 
Flame Failure Device:	Yes

Features

- Italian made Defendi* Dual brass burner;
- 18MJ/h Supreme firepower;
- Upper air-intake;
- Flame failure protection;
- Disassemble burner;
- Premium Grade 304# Stainless Steel surface;

Certificate

IAPMO

Installation

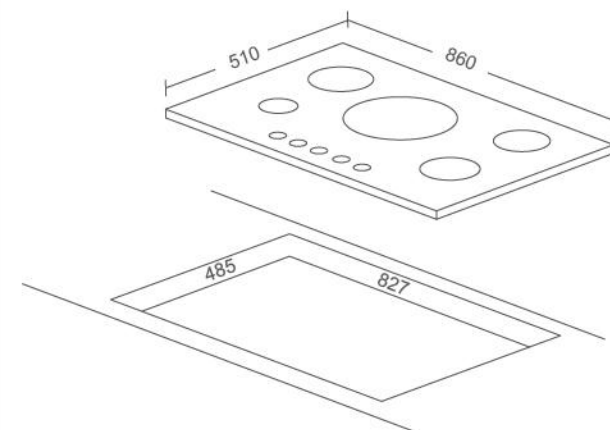

JZ(Y/T)-G513



Product Size:	30x21x2 ³ / ₅ "
Installation Size:	28x19"
Heat Flow (BTU):	20000, 13000, 9500x2, 5000
Flame Failure Device:	Yes

*SPECIALLY FOR NORTH AMERICAN KITCHENS 

Features

- Italian made, Defendi* Dual brass burner;
- 20000BTU Supreme firepower;
- Upper air-intake;
- Flame failure protection;
- Disassemble burner;
- Premium grade 304# stainless steel surface;

Certificate

cETLus / cCSAus / FCC / CEC / IC

Installation

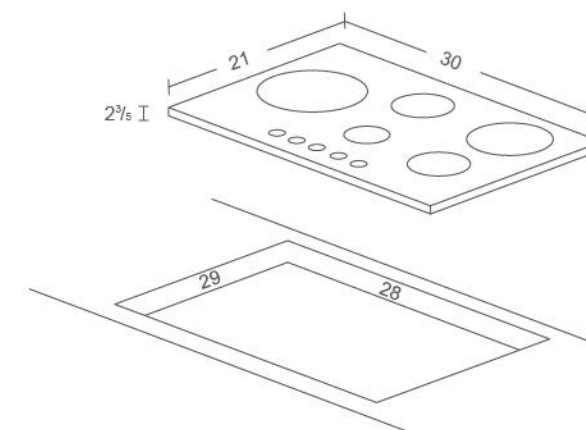

JZ(Y/T)-G515



Product Size:	36x21x2 ³ / ₅ "
Installation Size:	34x19"
Heat Flow (BTU):	20000, 13000, 9500x2, 5000
Flame Failure Device:	Yes

*SPECIALLY FOR NORTH AMERICAN KITCHENS 

Features

- Italian made, Defendi* Dual brass burner;
- 20000BTU Supreme firepower;
- Upper air-intake;
- Flame failure protection;
- Disassemble burner;
- Premium grade 304# stainless steel surface;

Certificate

cETLus / cCSAus / FCC / CEC / IC

Installation

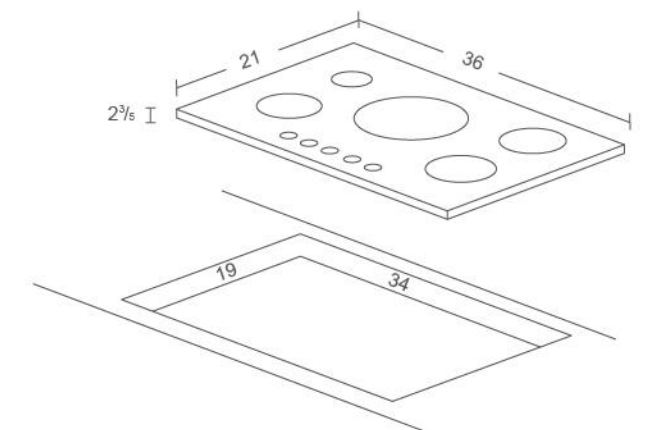

JZ(Y/T)-B928



Product Size:	760x450x162mm
Installation Size:	703x403mm
Heat Flow (kW):	4.5x2 
Flame Failure Device:	Yes

Features

- 4.5kW Heat flow rate;
- High quality copper burners;
- 112 Flaming holes with multi angle makes the fire well-distributed;
- Easy cleaning with removable burner;
- 8mm Tempered glass surface;
- Flame failure protection;

Certificate

SIRIM / ISI

Installation

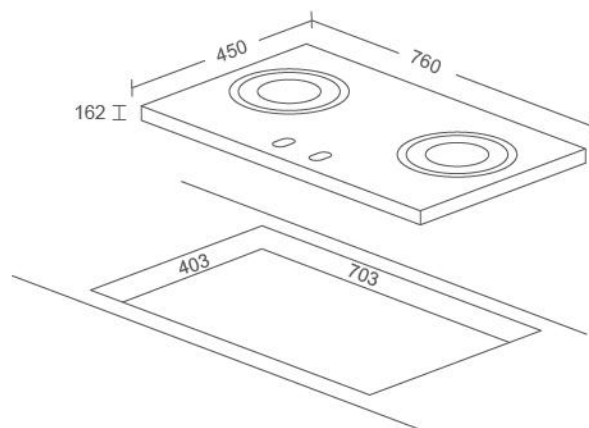

JZ(Y/T)-B292



Product Size:	780x450x142mm
Installation Size:	700x400mm
Heat Flow (kW):	4.6x2
Flame Failure Device:	Yes

Features

- 5.0 kW strong firepower, so the heat can penetrate to ingredients fast and uniformly with delicious flavor;
- The Innovative technology 3D flame equips with 172 direct-fire holes which improves combustion efficiency and burning uniformly;
- Eight-directions oxygen intake channel supplies circulating oxygen and the flame sprays steadily without shake;
- Increase the diameter of aluminum alloy base, so the power supply and efficiency can be improved;

Certificate

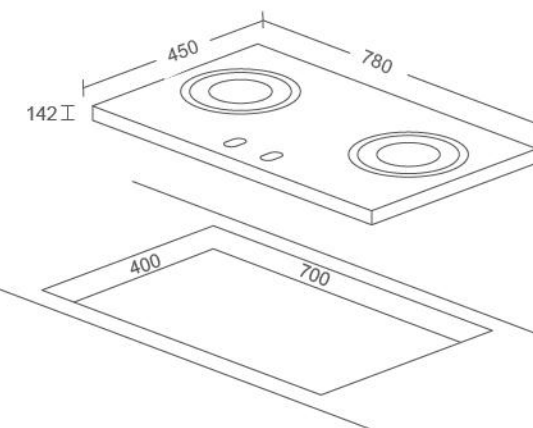

EN30

Installation



JZ(Y/T)-B397



Product Size:	860x450x160mm
Installation Size:	760x400mm
Heat Flow (kW):	4.5x2, 1.8x1 
Heat Flow (kW):	4.2x2, 1.6x1 
Flame Failure Device:	Yes

Features

- 4.5kW Heat flow rate;
- High quality copper burners;
- 112 Flaming holes with multi angle makes the fire well-distributed;
- Easy cleaning with removable burner;
- 8mm Tempered glass surface;
- Flame failure protection;

Certificate

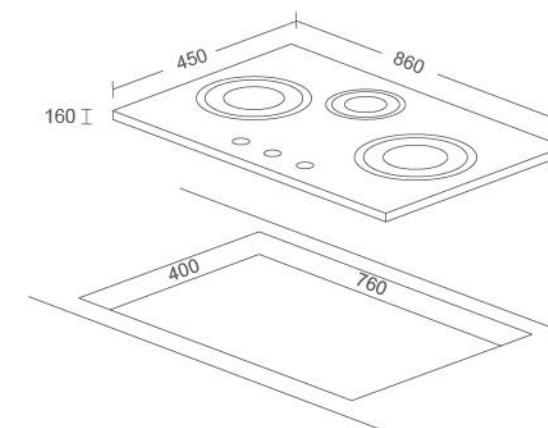

SIRIM / ISI

Installation



JZ(Y/T)-B482



Product Size:	800x525x160mm
Installation Size:	753x478mm
Heat Flow (kW):	4.5x2, 1.8x2 
Heat Flow (kW):	4.0x2, 1.6x2 
Flame Failure Device:	Yes

Features

- 4.5kW Heat flow rate;
- High quality copper burners;
- 112 Flaming holes with multi angle makes the fire well-distributed;
- Easy cleaning with removable burner;
- 8mm Tempered glass surface;
- Flame failure protection;

Certificate

ISI / ECAS

Installation

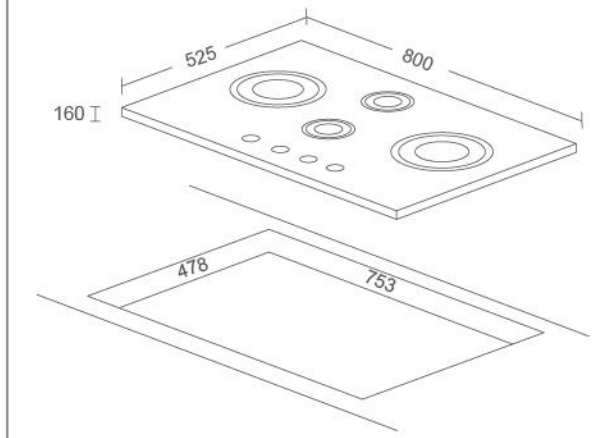

JZ(Y/T)-B396



Product Size:	860x525x154mm
Installation Size:	753x478mm
Wok Burner (kW):	4.5x2, 1.8x1
Flame Failure Device:	Yes

Features

- High quality copper burners;
- 4.5kW high firepower;
- Flame failure protection;
- Disassemble burner;
- Easy cleaning surface;

Certificate

SIRIM

Installation

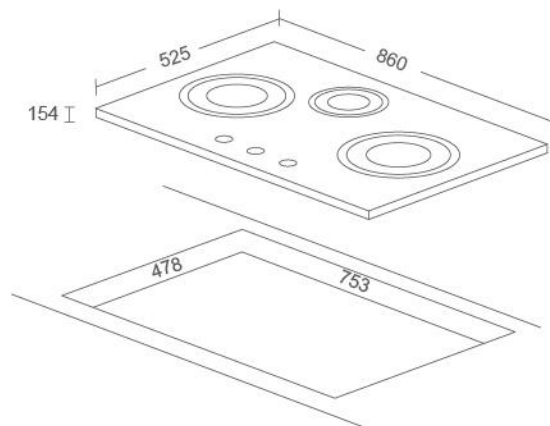

JZ(Y/T)-B398



Product Size:	700x525x150mm
Installation Size:	653x478mm
Wok Burner (kW):	4.2x2, 1.6x1
Flame Failure Device:	Yes

Features

- High quality copper burners;
- 4.5kW high firepower;
- Flame failure protection;
- Disassemble burner;
- Easy cleaning surface;

Certificate

BIS

Installation

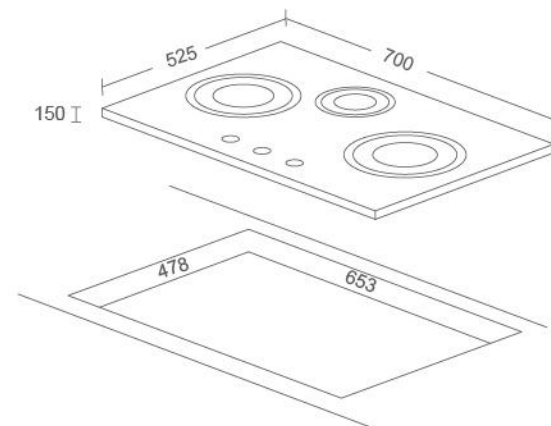

JZ(Y/T)-B486



Product Size:	700x525x154mm
Installation Size:	655x478mm
Heat Flow (kW):	4.5x1, 2.3x1, 1.8x2
Heat Flow (kW):	14.4x1, 5.76x2, 7.2x1
Heat Flow (kW):	4.2x1, 1.6x2, 2.1x1
Flame Failure Device:	Yes

Features

- High quality copper burners;
- 4.5kW high firepower;
- Flame failure protection;
- Disassemble burner;
- Easy cleaning surface;

Certificate

BIS / LOA / SONCAP

Installation

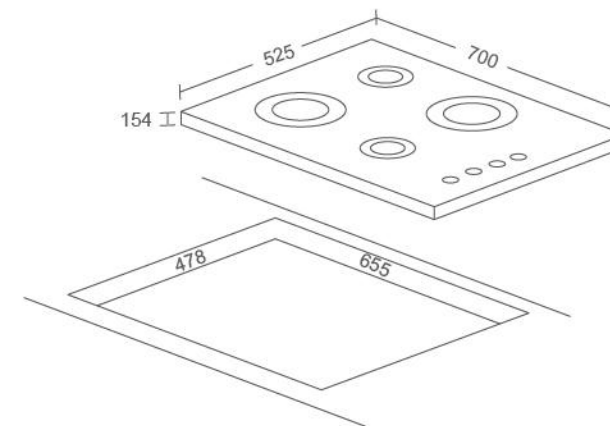

JZ(Y/T)-B582



Product Size:	900x550x155mm
Installation Size:	853x503mm
Heat Flow (kW):	4.5x1, 2.3x2, 1.8x2
Heat Flow (kW):	4.0x1, 2.0x2, 1.6x2
Flame Failure Device:	Yes

Features

- High quality copper burners;
- 4.5kW high firepower;
- Flame failure protection;
- Disassemble burner;
- Easy cleaning surface;

Certificate

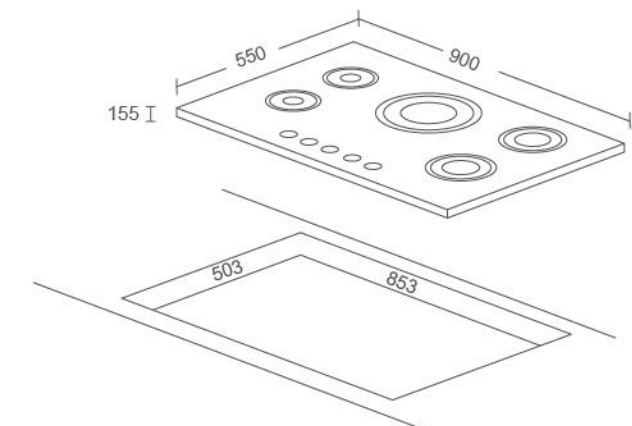

BIS / ECAS / SONCAP

Installation



JZ(Y/T)-B320



Product Size:	900x525mm
Installation Size:	825x475mm
Heat Flow (MJ/h):	17x2, 7.2x1  
Flame Failure Device:	Yes

Features

- High quality copper burners;
- 17MJ/h high firepower;
- Four-direction air inlet makes the fire well-distributed;
- Flame failure protection;
- Disassemble burner;
- Easy cleaning surface;

Certificate

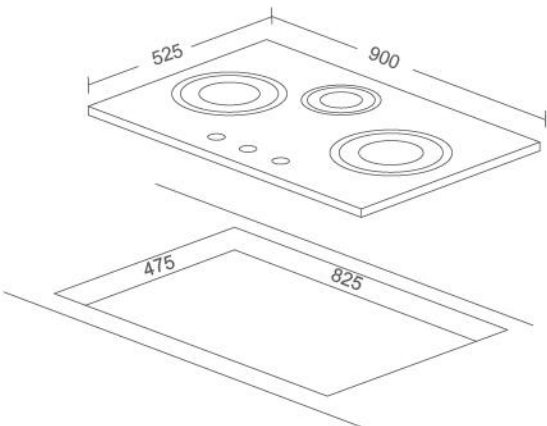

IAPMO

Installation



JZ(Y/T)-B322



Product Size:	600x525mm
Installation Size:	555x475mm
Heat Flow (MJ/h):	17x1, 7.2x1, 3.6x1  
Flame Failure Device:	Yes

Features

- High quality copper burners;
- 17MJ/h high firepower;
- Four-direction air inlet makes the fire well-distributed;
- Flame failure protection;
- Disassemble burner;
- Easy cleaning surface;

Certificate

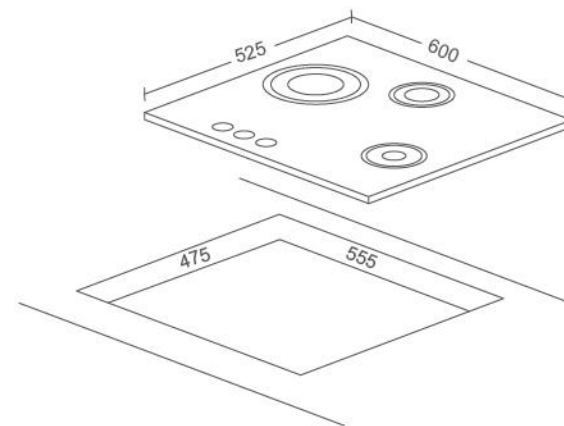

IAPMO

Installation



JZ(Y/T)-B420



Product Size:	600x525mm
Installation Size:	555x475mm
Heat Flow (MJ/h):	17x1, 10.5x1, 7.2x1, 3.6x1  
Flame Failure Device:	Yes

Features

- High quality copper burners;
- 17MJ/h high firepower;
- Four-direction air inlet makes the fire well-distributed;
- Flame failure protection;
- Disassemble burner;
- Easy cleaning surface;

Certificate

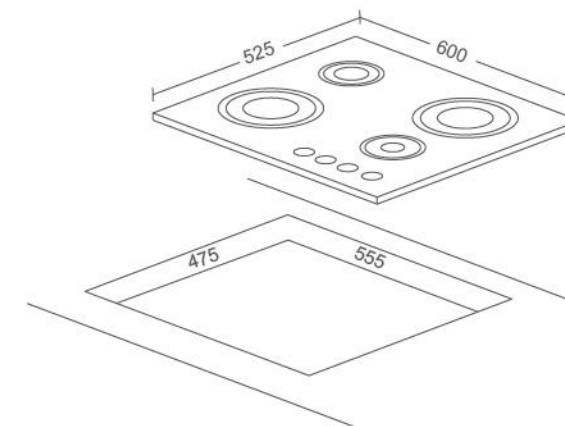

IAPMO

Installation



JZ(Y/T)-B520



Product Size:	900x525mm
Installation Size:	825x475mm
Heat Flow (MJ/h):	17x1, 10.5x1, 7.2x2, 3.6x1  
Flame Failure Device:	Yes

Features

- High quality copper burners;
- 17MJ/h high firepower;
- Four-direction air inlet makes the fire well-distributed;
- Flame failure protection;
- Disassemble burner;
- Easy cleaning surface;

Certificate

IAPMO

Installation

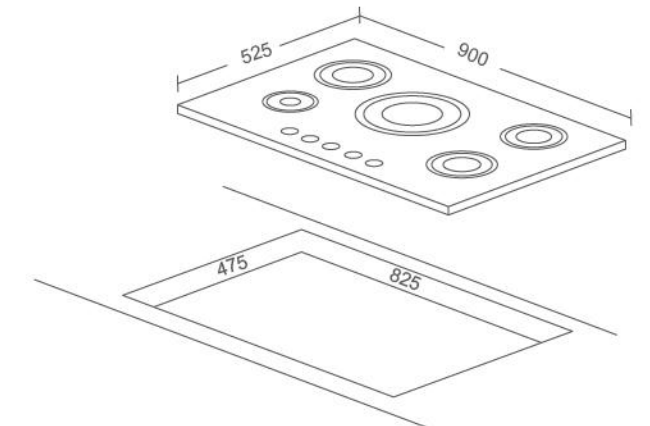

JZ(Y/T)-G271



Product Size:	720x420x135mm
Installation Size:	650x350mm
Heat Flow (kW):	4.2x2
Flame Failure Device:	Yes

Features

- Four-channel fire divider fully optimizes the airways and flame erupts in all directions;
- Three-dimensional oxygen supply, easy to burn good taste;
- Waterproof decorative panel, saving cleaning effort;
- Single gas and fire control, warm your stomach and heart;

Certificate

EN30

Installation

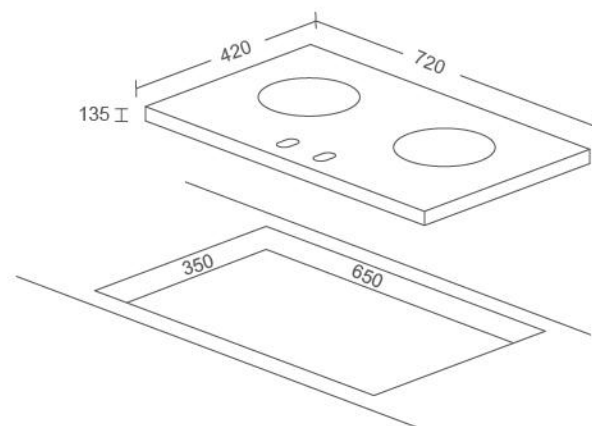

JZ(Y/T)-B272



Product Size:	780x450x142mm
Installation Size:	700x400mm
Heat Flow (kW):	4.2x2
Flame Failure Device:	Yes

Features

- 4.8kW Powerful fire;
- Self-adaption size;
- Disassemble burner;
- Flame failure protection;
- Tempered glass surface;

Certificate

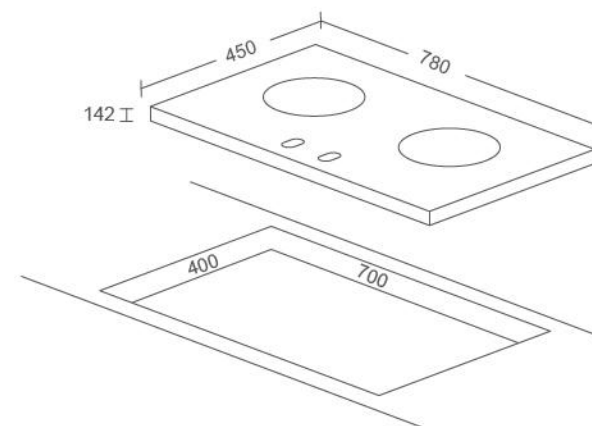

EN30

Installation



JZ(Y/T)-B276



Product Size:	760x450x135mm
Installation Size:	650x350mm
Heat Flow (kW):	4.4x2  
Flame Failure Device:	Yes

Features

- 4.4kW firepower;
- Four-ring flame from the inside;
- Four sets of oxygen aeration grooves, makes cooking sufficiently;
- Flame failure protection;

Certificate

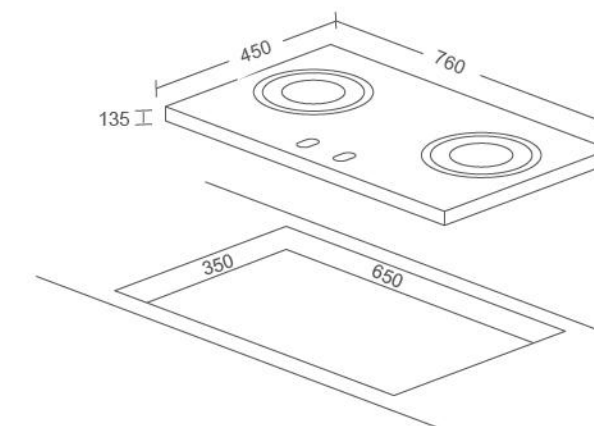

SIRIM

Installation



JZ(Y/T)-G370



Product Size:	860x500x157mm
Installation Size:	820x450mm
Heat Flow (kW):	4.4x2, 1.8x1  
Heat Flow (kW):	5.0x2, 2x1 
Flame Failure Device:	Yes

Features

- 4.4kW firepower;
- Four-ring flame from the inside;
- Four sets of oxygen aeration grooves, makes cooking sufficiently;
- Flame failure protection;

Certificate

SIRIM

Installation

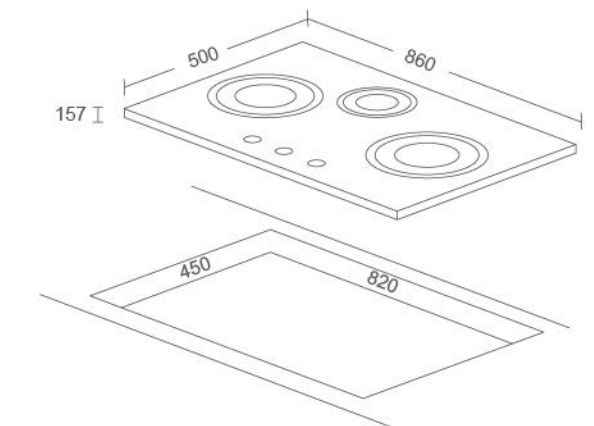

JZ(Y/T)-B920



Product Size:	780x450x138mm
Installation Size:	703x403mm
Heat Flow (kW):	4.5x2
Flame Failure Device:	Yes

Features

- 4.5kW high firepower;
- Flame failure protection;
- Disassemble burner;
- Easy cleaning surface;

Certificate

SIRIM

Installation

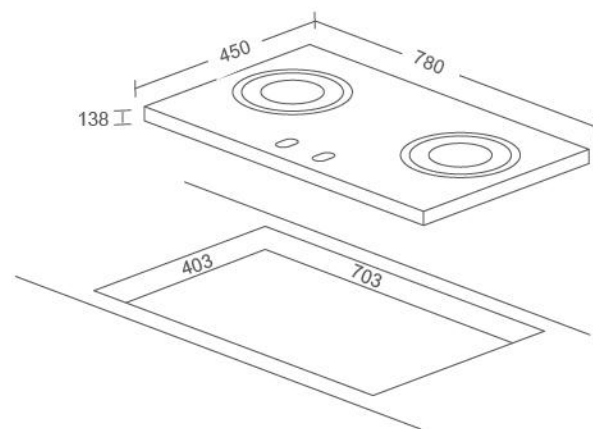

HS30-W810

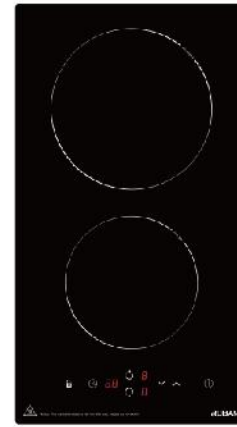

Product Size:	288x520x62mm
Installation Size:	268x500mm
Power: Front Zone:	1200W / 165mm
Rear Zone:	1800W / 200mm
Cooking Zone:	2

Features

- Easy to use;
- Easy-to-clean surface;
- Less space occupied;

Installation

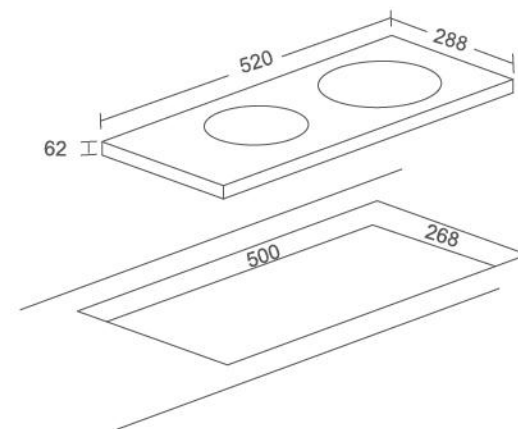

CS35-W860

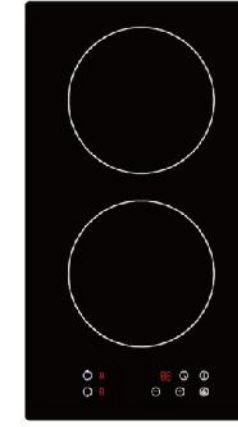

Product Size:	288x520x62mm
Installation Size:	268x500mm
Power: Front Zone:	1500W / 160mm
Rear Zone:	2000W / 180mm
Cooking Zone:	2

Features

- Easy to use;
- Easy-to-clean surface;
- Less space occupied;
- Different size zones can meet your various cooking needs at the same time;

Installation

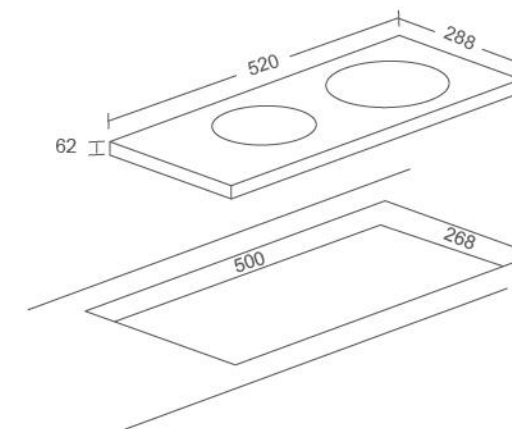

CS35-W211



Product Size:	750x430x52mm (LxWxH)
Installation Size:	695x410mm
Total Power:	4400W
Supply Voltage:	220-240V~ / 50-60Hz
Cooking Zone:	2

Features

- Easy to use;
- Easy-to-clean surface;
- Less space occupied;
- Different size zones can meet your various cooking needs at the same time;

Installation

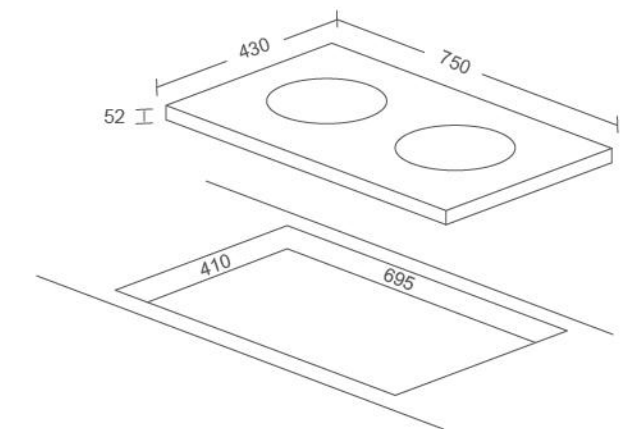

CS40-W261



Product Size:	750x430x62mm
Installation Size:	695x410mm
Power: Left:	2000W / 210mm
Right:	2400W / 210mm
Cooking Zone:	2

Features

Slider control;
Boost;
Keep warm;
Stop + Go;

Certificate

SIRIM

Installation

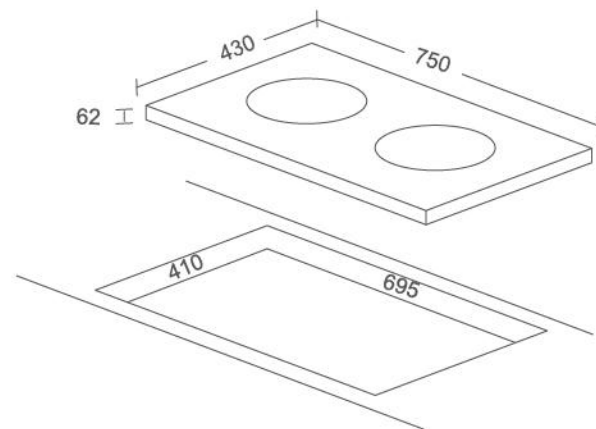

CS46-W270



Product Size:	750x430x55mm
Installation Size:	695x410mm
Power: Left:	2200/1000W / 230/138mm
Right:	2000W B=2400W / 210mm
Cooking Zone:	2

Features

Slider control;
Dual zone; (Only infrared furnace)
Boost; (Only induction cooker)
Keep warm;
Stop + Go;

Certificate

SIRIM

Installation

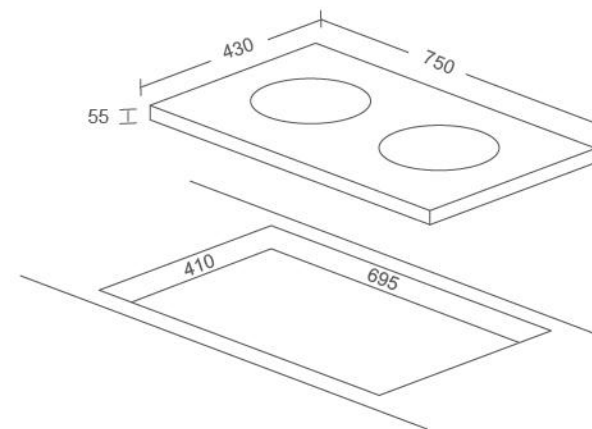

CD70-W460P



Product Size:	590x520x55mm
Installation Size:	560x490mm
Power: Left Front Zone:	2000W/180mm
Left Rear Zone:	1500W/160mm
Right Rear Zone:	2000W/180mm
Right Front Zone:	1500W/160mm
Cooking Zone:	4

Features

Strong power;
Precise temperature control with 9 power levels;
Individual control timer;
Child lock;
overheat protection;
Heat warning;

Certificate

RCM

Installation

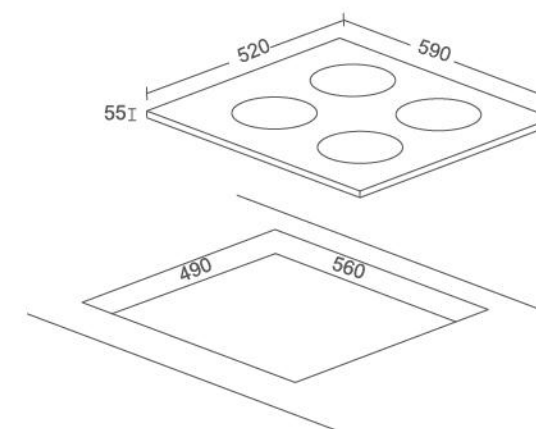

CD70-W561



Product Size:	900x520x62mm
Power: Left Front Zone:	2000W Boost 2600W
Left Rear Zone:	1500W Boost 2000W
Right Front Zone:	2000W Boost 2600W
Right Rear Zone:	1500W Boost 2000W
Middle Zone:	2300W Boost 3000W

Features

Five-hole induction cooker;
Aluminum wrap around the tamish;
Total power 7200W;
Warm function;
Left cooking area is none area;

Certificate

LOA / CoC / GCC / ECAS / RoHS / Saber

Installation

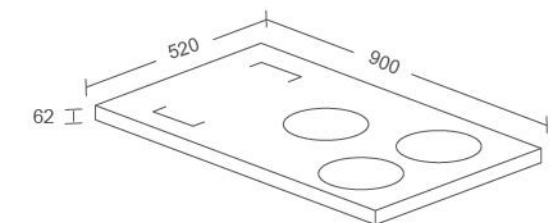



OVEN

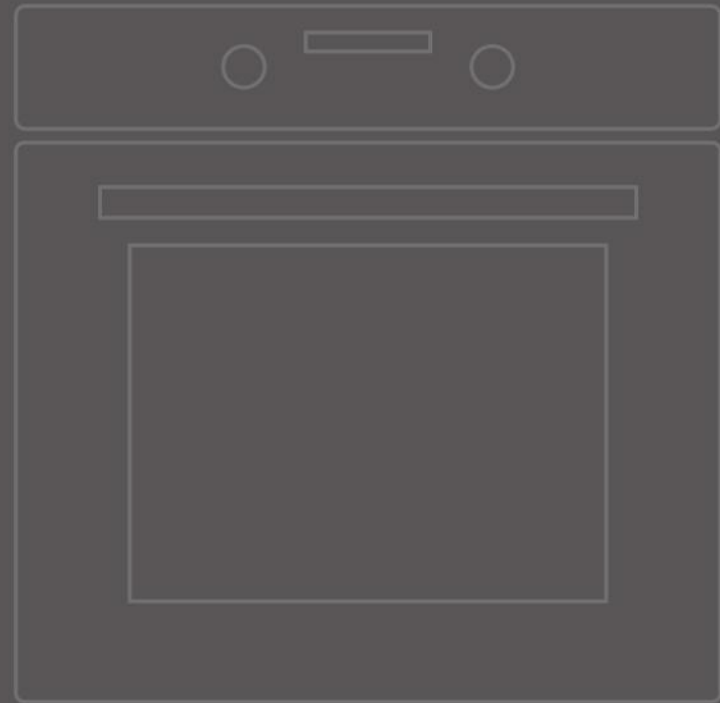

OVEN



1 Dual temperature and dual control.

2 Intelligent control ensures precise 1°C temperature control.

3 4+1 multi-dimensional heating tubes.

4 360° rotating roast, all rounded heating helps you deal with food difficult to cook.

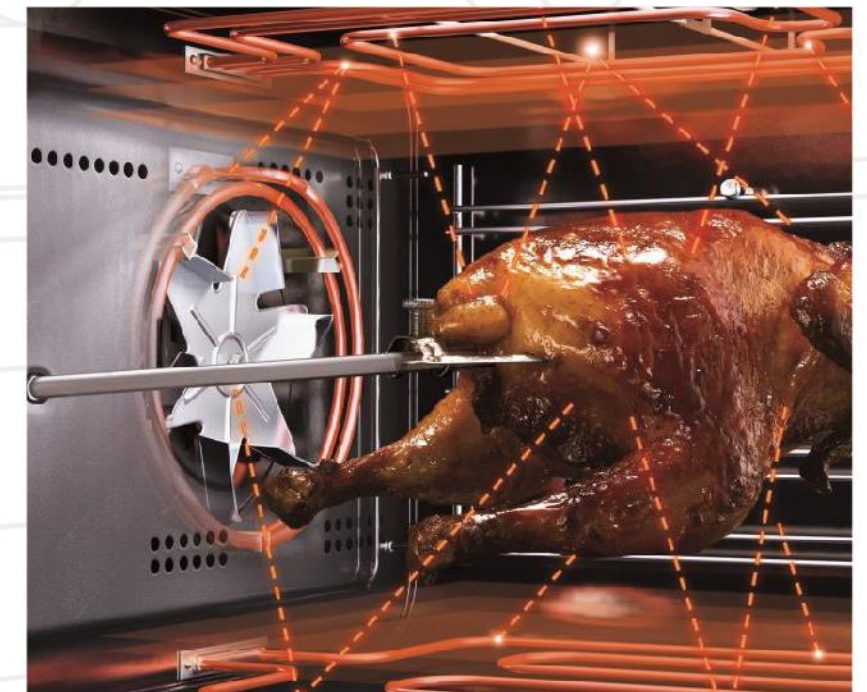

KQWS-3000-R335



Product Size:	595x595x520mm (WxHxD)
Power Rating:	3000W
Capacity:	65L
Half Installation Size:	560x590x550mm (WxHxD)
Full Installation Size:	600x600x565mm (WxHxD)

Features

- Double cavity in one machine;
- Separate temperature control;
- 2 Convection fans;
- 65L Family-sized capacity;
- Roasting rotisserie;
- Intelligent cooking menu;
- Durable enamel cavity;
- Fully LCD display & sensor touch control;

Certificate

CB / CE / RCM / ETL / BMSI

Installation

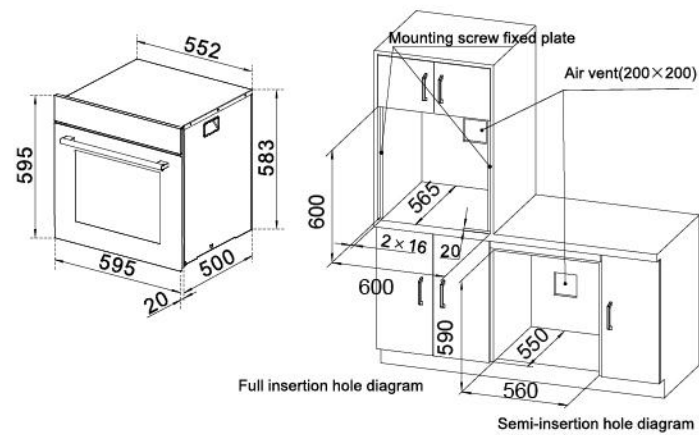

KQWS-3000-R332



Product Size:	595x595x520mm (WxHxD)
Power Rating:	3000W
Capacity:	65L
Half Installation Size:	560x590x550mm (WxHxD)
Full Installation Size:	600x600x565mm (WxHxD)

Features

- Fully LCD display & knob control;
- Convection fan;
- 65L Family-sized capacity;
- Roasting rotisserie;
- Intelligent cooking menu;
- Durable enamel cavity;

Certificate

CB / CE / RCM / ETL / BMSI

Installation

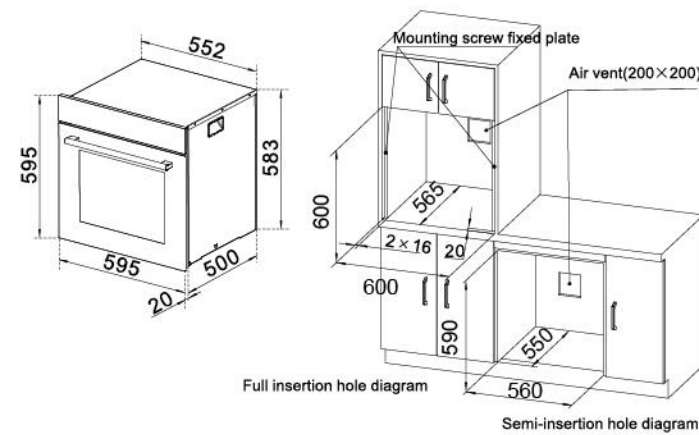

KQWS-2800-R312



Product Size:	595x595x520mm (WxHxD)
Power Rating:	2800W
Capacity:	60L
Half Installation Size:	560x590x550mm (WxHxD)
Full Installation Size:	600x600x565mm (WxHxD)

Features

- Independent top & bottom temperature control;
- 1°C precise control;
- 3D roasting tube;
- Roasting rotisserie;
- Fully LCD display & sensor touch control;
- 8 Cooking function;
- 3-Layer glass door with 2 layers of low-E-glass;
- High-temperature protection;
- Durable enamel cavity and trays;
- Removable racks;
- Easy cleaning roasting tubes;

Certificate

RCM / SIRIM / LOA / CoC / GCC / ECAS / RoHS

Installation

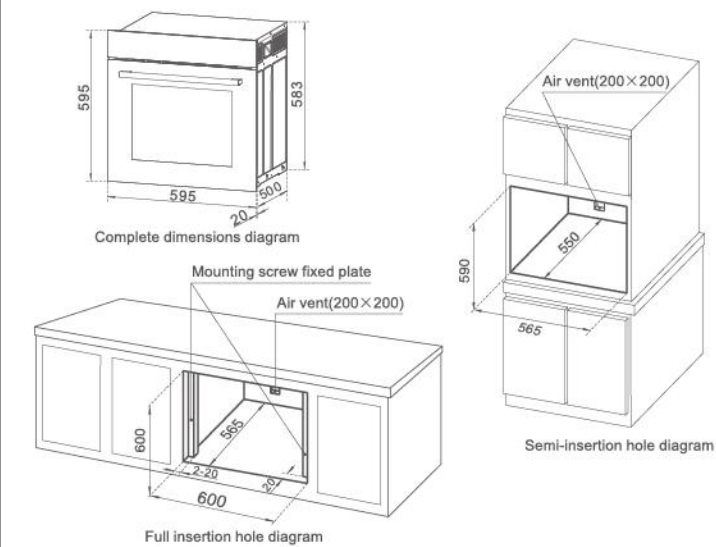

KQWS-2800-R306



Product Size:	595x595x520mm (WxHxD)
Power Rating:	2800W
Capacity:	56L
Half Installation Size:	560x590x550mm (WxHxD)
Full Installation Size:	600x600x565mm (WxHxD)

Features

- 1°C precise control;
- 3D roasting tube;
- 8 Cooking Function;
- Semi-mechanical feature;
- 3-Layer glass door with 2 layers of low-E-glass;
- High-temperature protection;
- Durable enamel cavity and trays;
- Removable racks;
- Easy cleaning roasting tubes;

Certificate

RCM / SIRIM / LOA / CoC / GCC / ECAS / RoHS

Installation

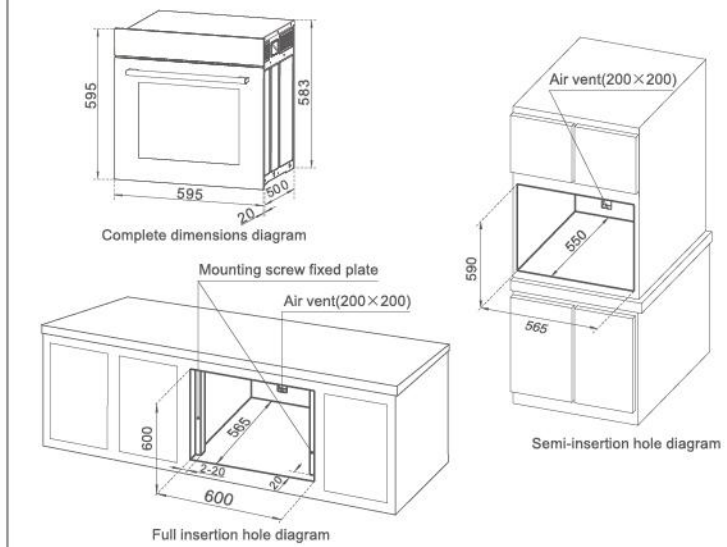

KQWS-3150-R313



Product Size:	595x595x531mm (WxHxD)
Power Rating:	3150W
Capacity:	60L
Cut out size:	564x600x560mm (WxHxD)

Features

- 9 Functions;
- Convenient knob control;
- Easy cleaning enamel interior;

Certificate

GCC / Saber

Installation

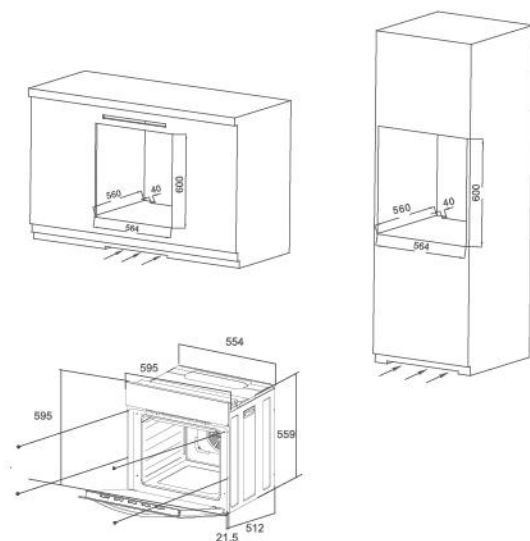

KQWS-2350-R315B/S



Product Size:	595x595x531mm (WxHxD)
Power Rating:	2350W
Capacity:	59L
Half Installation Size:	564x600x560mm (WxHxD)
Full Installation Size:	600x600x560mm (WxHxD)

Features

- 6 Functions;
- 3+1 Dimension heating;
- Convenient knob control;
- Easy cleaning enamel interior;
- S/Steel surface or tempered glass surface selectable;

Certificate

RCM / SONCAP

Installation

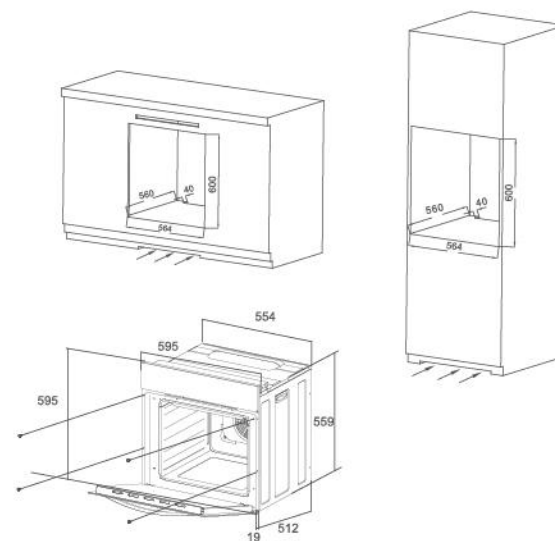

KQWS-4800-R330



Product Size:	29-7/8 x 28-7/16 x 23-1/2" (WxHxD)
Power Rating:	4800W
Capacity:	5.0 cu.ft
Glass Insulation:	4 Layer glass door

Features

- 4D Hot air;
- Food probe;
- Pyrolytic cleaning at 842 F ;
- Durable enamel cavity and trays;
- 4 Layers of insulating glass;
- 5.0cu.ft Super cubage;
- 5 Baking function;
- Sabbath mode;

Certificate

cETLus / IC / NRcan / FCC / CEC

Installation

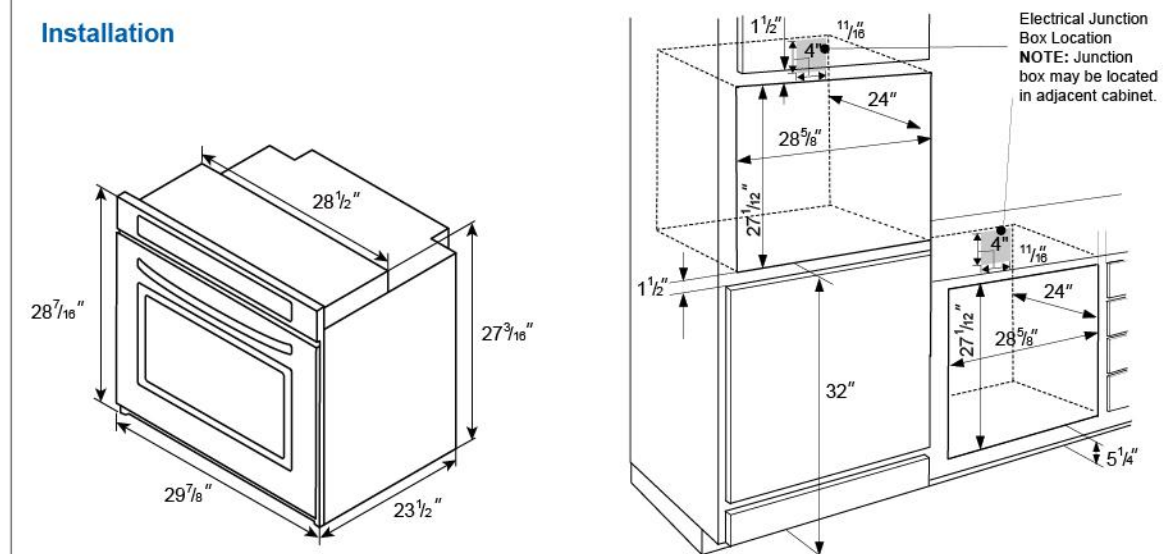

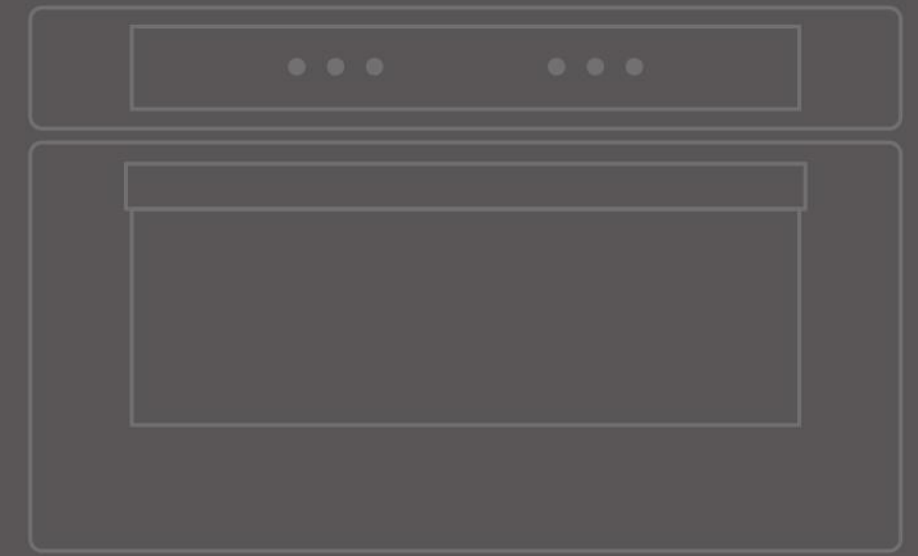

STEAM OVEN

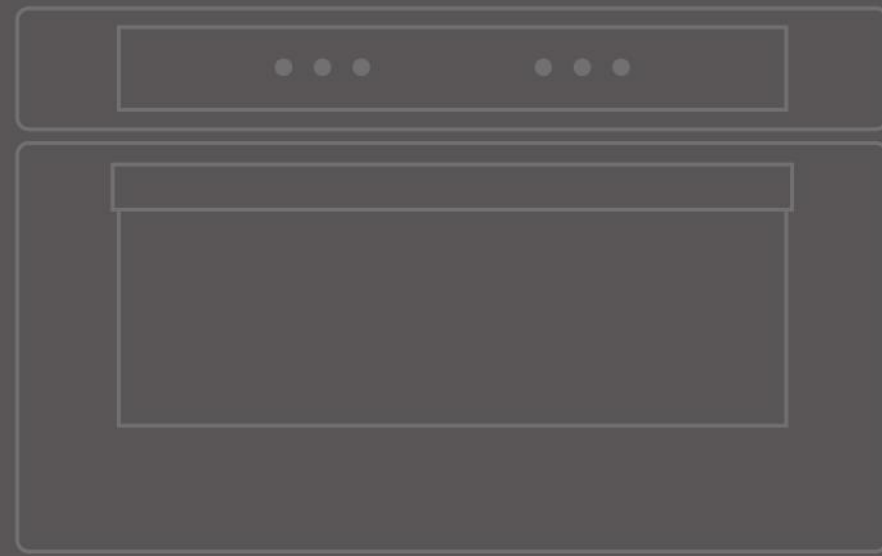

STEAM OVEN

1 U-shaped heating tubes ensure that the top does not drip and the food would be delicious.

2 With 105°C high temperature steaming, even food difficult to cook can be thoroughly steamed.

3 With bottom double tube heating plate, quick steaming retain the nutrition of the food.

4 Top electric water tank.



ZQB400-S112



Product Size:	595x455x520mm (WxHxD)
Power Rating:	2100W
Capacity:	40L
Half Installation Size:	560x450x550mm (WxHxD)
Full Installation Size:	600x460x565mm (WxHxD)

Features

- 3D steaming;
- 105° powerful steaming;
- Smell isolating system;
- 8 intelligent of cooking modes;
- 1°C precise temperature control;
- Electric external water tank;
- Medical grade 304 stainless steel inner tank;
- Fully LCD display & sensor touch control;

Certificate

RCM / SIRIM / SONCAP

Installation

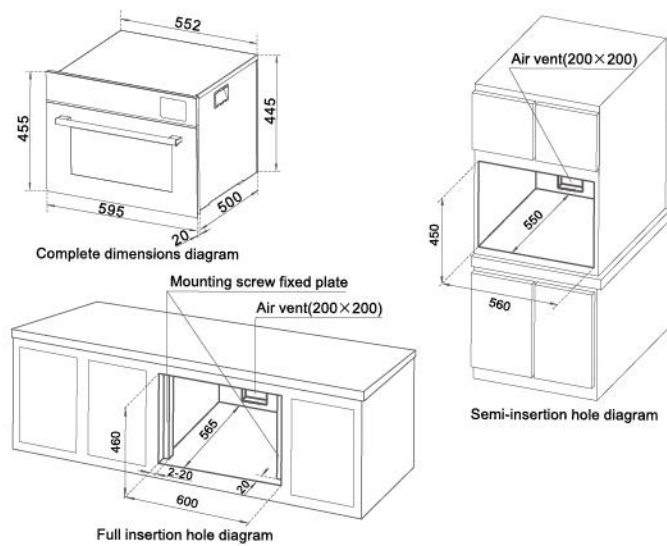

ZQB400-S106



Product Size:	595x455x520mm (WxHxD)
Power Rating:	2100W
Capacity:	40L
Half Installation Size:	560x450x550mm (WxHxD)
Full Installation Size:	600x460x565mm (WxHxD)

Features

- 3D Steaming;
- 105° powerful steaming;
- Smell isolating system;
- 7 cooking function;
- 1°C precise temperature control;
- Electric external water tank;
- Medical grade 304 stainless steel inner tank;
- Smart Push Up Knob;

Certificate

RCM / SIRIM / SONCAP

Installation

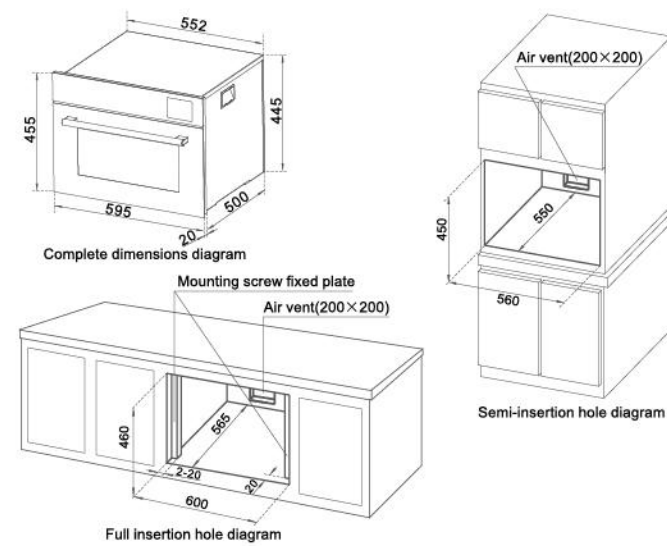

ZTB250-ST10



Product Size:	530x362x390mm (WxHxD)
Power Rating:	1800W
Capacity:	25L
Net Weight:	17kg

Features

- Free of installation;
- 3D Steaming technology;
- 20 Preset recipes;
- Multiple function in one machine;
- 1°C precise temperature control;
- Electric external water tank;
- Medical grade 304 stainless steel inner tank;
- Fully LCD display & sensor touch control;

Certificate

RCM / SIRIM

Installation

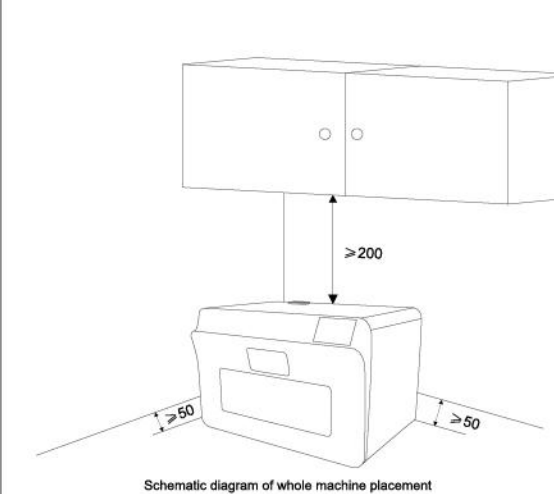

ZQB135-SZ100



Product Size:	380x480x220mm (WxHxD)
Power Rating:	1250W
Capacity:	13.5L
Installation Size:	357x457x220mm (WxHxD)

Features

- Table built-in design, cooking operation is more convenient;
- Hidden design to save kitchen space;
- Suitable for bamboo cage which can steam food freshly and bring good taste;
- Multi-layer bamboo cage superposition, large capacity is faster;
- Mode selection is more multiple, you can choose cooking modes according to the ingredients;
- With fermentation function and sterilization function;

Certificate

BSMI / RoHS

Installation

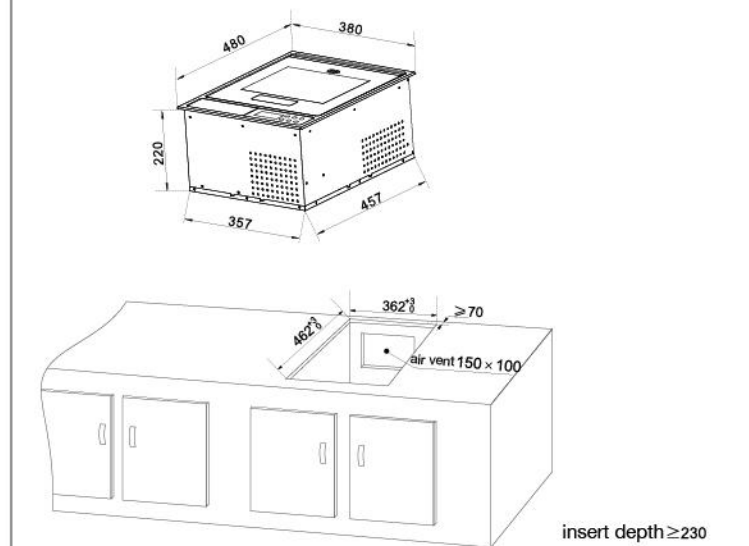

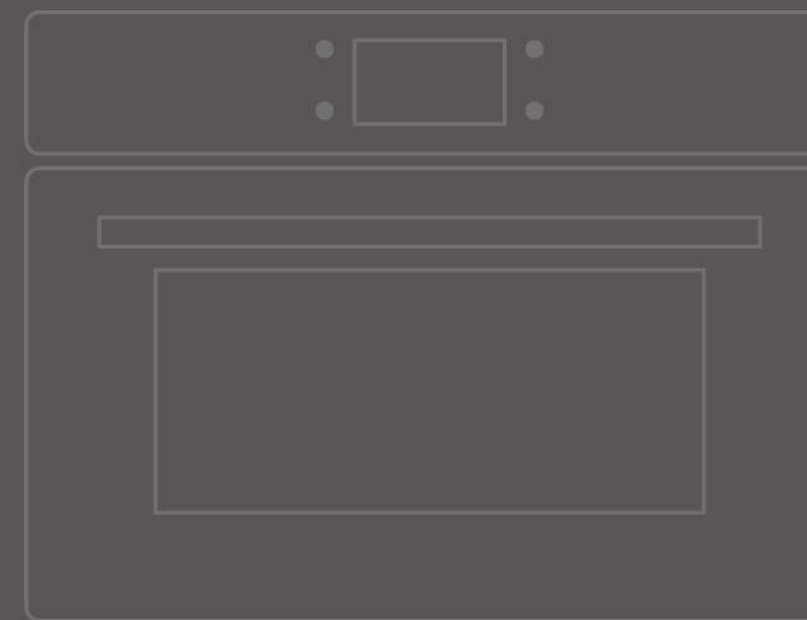

COMBI STEAM OVEN

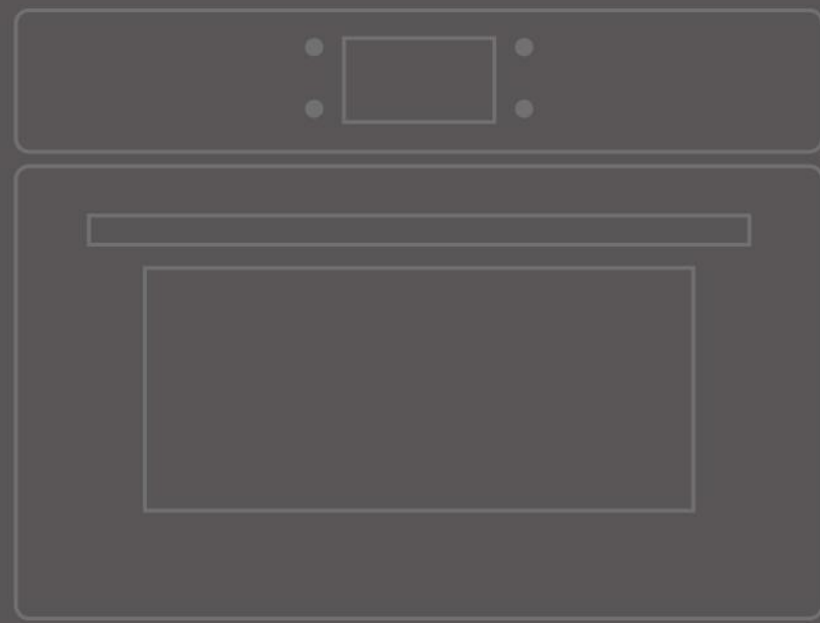

COMBI
STEAM OVEN



- 1** No water drops, no ponding water.
- 2** Lock the fresh and nutrients with ROBAM steaming technology.
- 3** Dual temperature with individual control system, create different flavors in one cooking process.

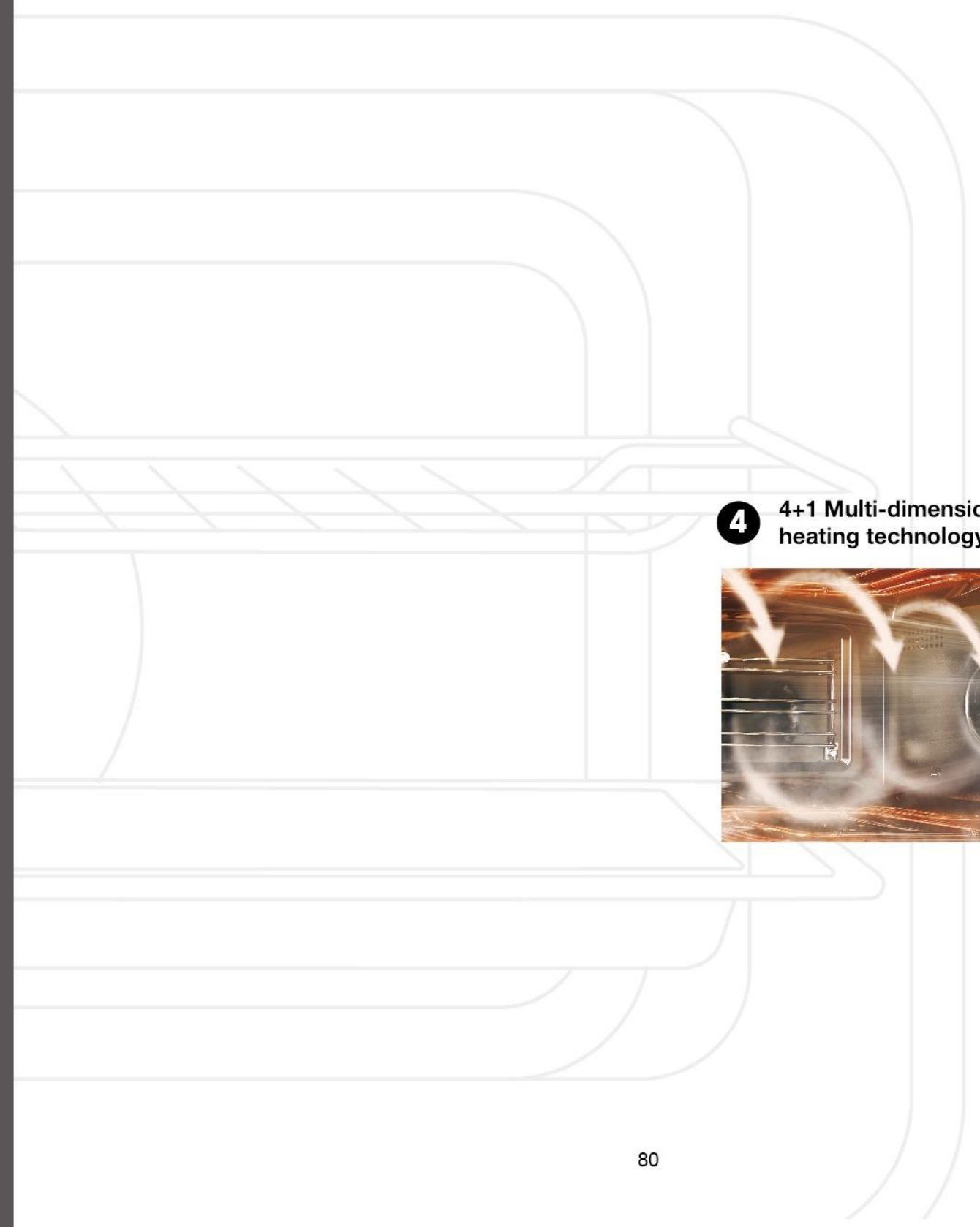

- 4** 4+1 Multi-dimensional heating technology.





⚠️ ⚠️ ⚠️
 Beware of electric shock opening the door avoiding from scald.
 Don't touch surface under working status avoiding scald.

KZQC-40-CQ751



Product Size:	595x455x520mm (WxHxD)
Power Rating:	2400W
Capacity:	40L
Half Installation Size:	560x450x550mm (WxHxD)
Full Installation Size:	600x460x565mm (WxHxD)

Features

- Grill with steam;
- 150° Powerful steaming;
- Fermentation, sterilization, defrost function;
- 3D cooking system;
- Intelligent cooking menu;
- Multi stage cooking setup;
- Durable enamel cavity;
- 3-Layer glass door with 2 layers of low-E-glass;
- TFT full colour touch screen;

Certificate

RCM / SIRIM / LOA / CoC

Installation

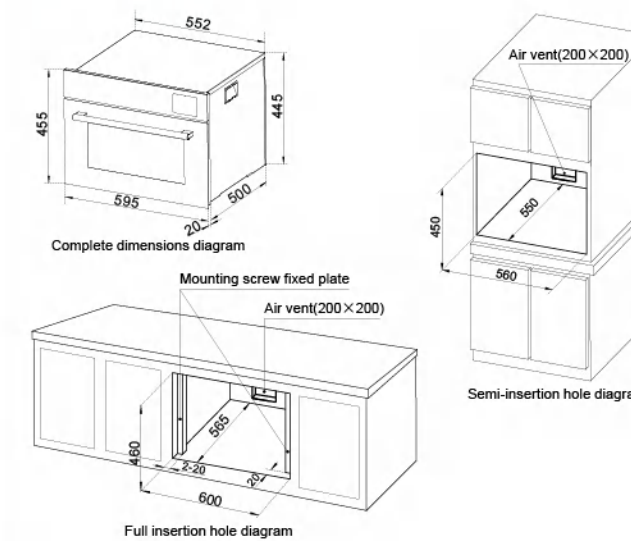

KZQY-48-CQ760B/S



Product Size:	595x455x550mm (WxHxD)
Power Rating:	3000W
Capacity:	48L
Net Weight:	31kg

*SPECIALLY FOR NORTH AMERICAN KITCHENS 🇺🇸 🇨🇦 🇩🇪

Features

- Redefine roasting space;
- Finish professional cooking easily;
- One-button brings chef level feast;
- Enjoy excellent taste;
- Intelligent humanized design;
- Solve cleaning trouble;

Certificate

cETLus / IC / NRcan / FCC / CEC

Installation

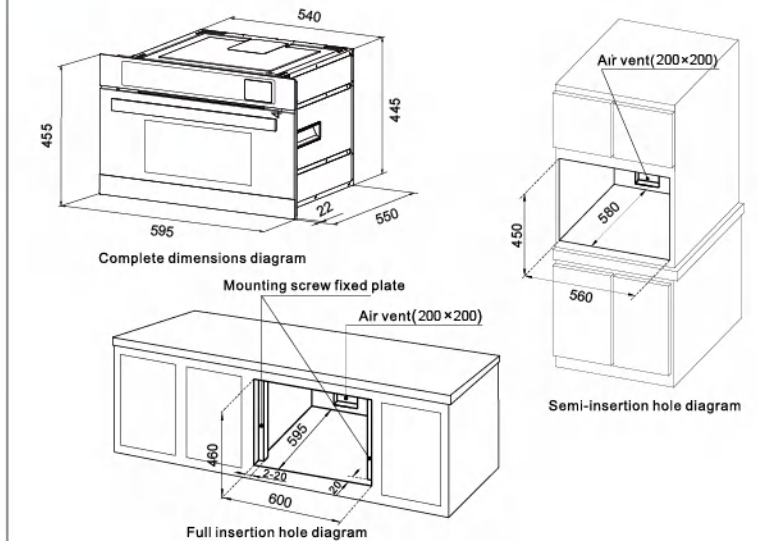

KZQY-48-CQ762B/S



Product Size:	760x455x550mm (WxHxD)
Power Rating:	3000W
Capacity:	48L
Half Installation Size:	725x450x580mm (WxHxD)
Full Installation Size:	765x460x595mm (WxHxD)

*SPECIALLY FOR NORTH AMERICAN KITCHENS 

Features

Grill with steam, makes it crispy and tender;
 5 \uparrow fine control;
 150° Powerfu steaming;
 Fermentation、sterilization、defrost and descaling function;
 3D cooking system;
 50 Customized recipes;
 3-Layer glass door with 2 layers of low-E-glass;
 Electric external water tank;
 304# S/Steel inner cavity;

Certificate

cETLus / IC / NRcan / FCC / CEC

Installation

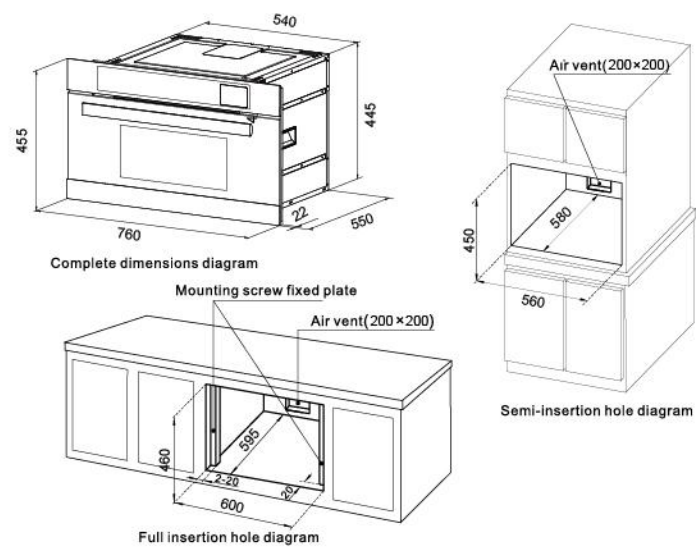

KZTS-26-CT761



Product Size:	505x350x480mm (WxHxD)
Power Rating:	1550W
Capacity:	26L
Net Weight:	14.6kg

Features

Free from installation;
 6 Professional cooking modes;
 26L Practical large capacity;
 Four auxiliary functions;
 Electric external water tank;

Certificate

cETLus / IC / NRcan / FCC / CEC

Installation

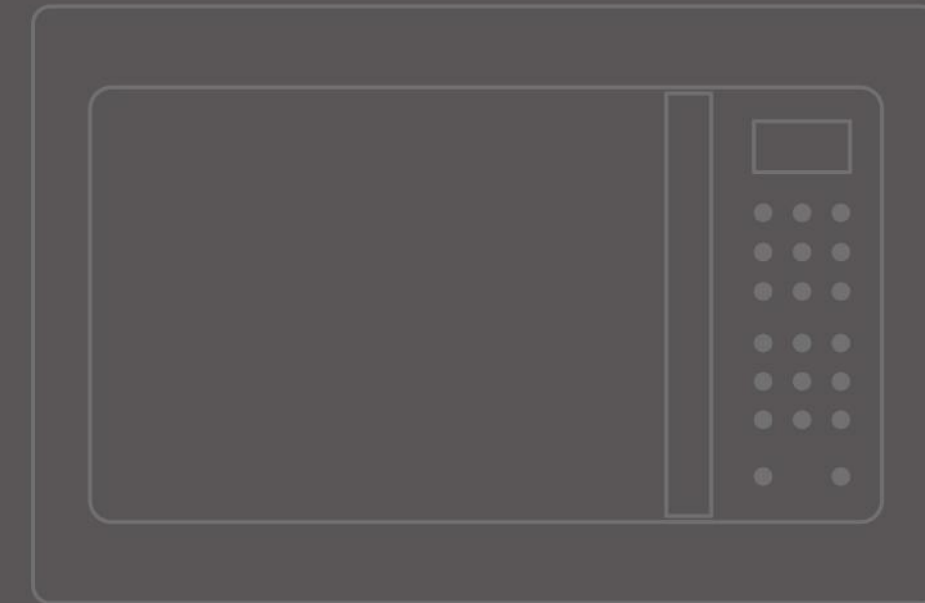
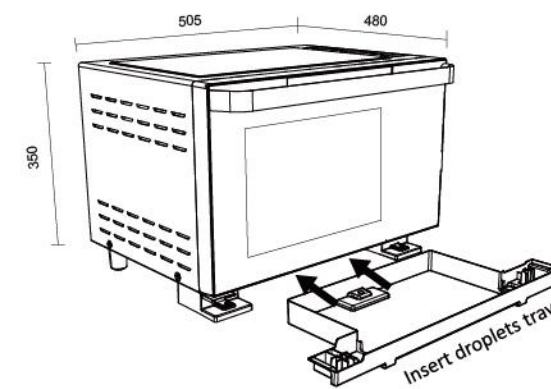

MICROWAVE
OVEN

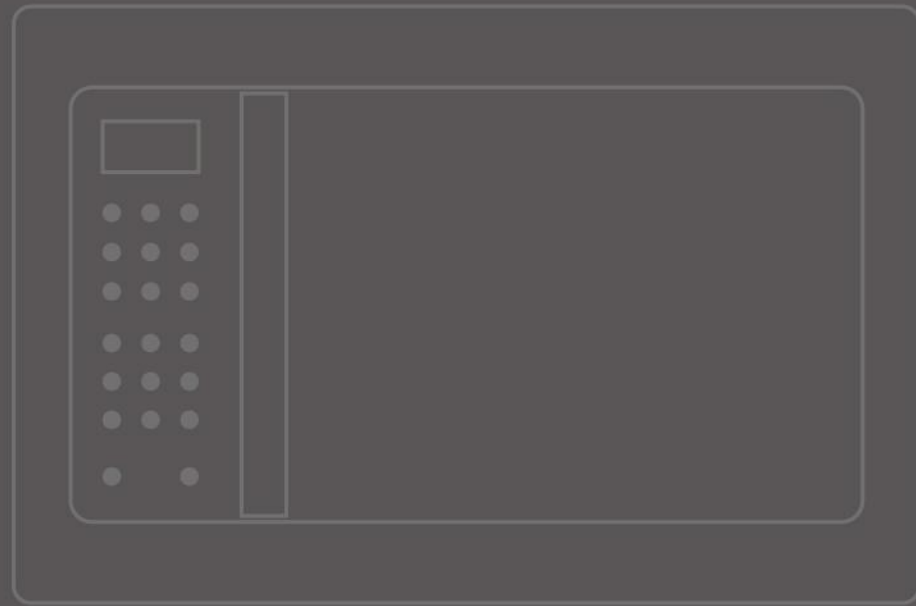

MICROWAVE OVEN

1 9 intelligent menus to make the seemingly complicated cooking so easy.



2 304 stainless steel healthy inner container to elaborately protect the health of yourself and your family.



3 Independent cyclic exhaust design: exhaust vent is designed at the front top area to make use of the hot air convection principle.



WK25-M612B/S



Product Size:	595x388x401mm (WxHxD)
Package dimensions:	653 × 466 × 500mm (WxHxD)
Gross weight / Net weight:	20.5/ 18.5kg
Loading capacity (20'/40'/40'HD):	194/408/408
Capacity:	25L

Features

Basic cooking functions

- Auto menu: 8
- Defrost by weight
- Defrost by time

Cooking convenience and safety

- Kitchen timer
- Add 30 sec
- Cooking end signal
- Child safety lock

Certificate

CB / SAA

Installation

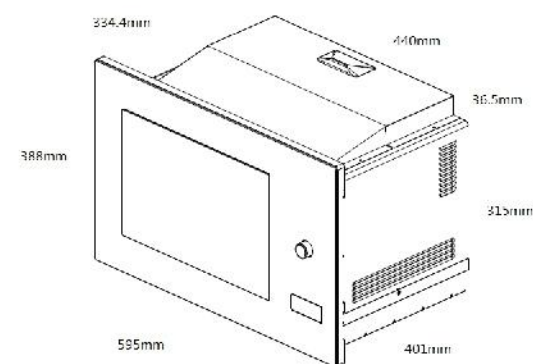

WK25-M613B/S

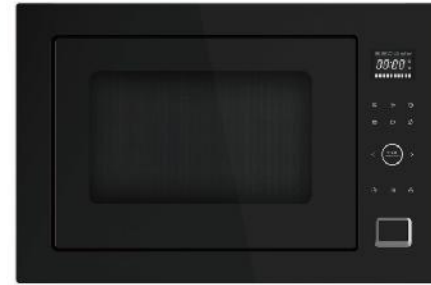

Product Size:	595x388x468mm (WxHxD)
Microwave input:	1550W
Microwave output:	1000W
Convection input:	2300W
Capacity:	34L

Features

- Touch control;
- Red LCD display;
- 10 Auto menu;
- 5 power levels & 4 combi;
- 95 min Kitchen timer;
- Speedy cooking + multi-stage cooking;
- Defrost by weight / time;
- Integrated design with outer frame;
- Child safety lock;

Certificate

CB / SAA

Installation

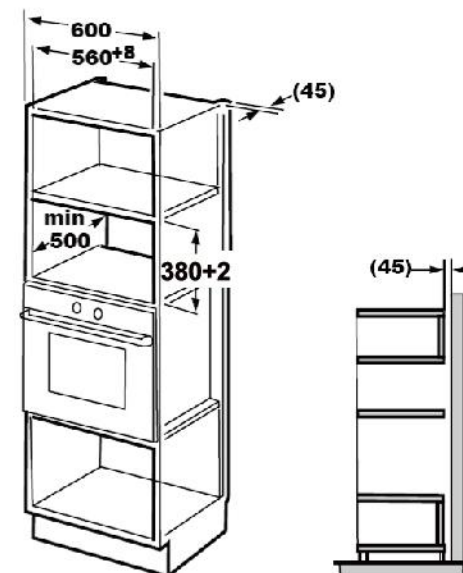

WK25-M602



Product Size:	595x390x400mm (WxHxD)
Cut out size:	560x380x550mm (WxHxD)
Rated Power Input(microwave):	1300W
Net Weight:	19kg
Capacity:	25L

Features

- 3 Modes;
- 1 °C precise control;
- 9 Auto cooking menus;
- 3 layers protection, no radiation;

Certificate

CB / GCC / SIRIM / RCM / BIS

Installation

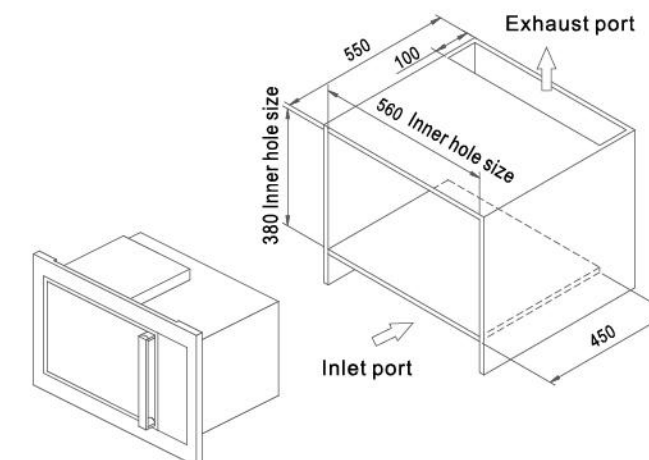



DISHWASHER

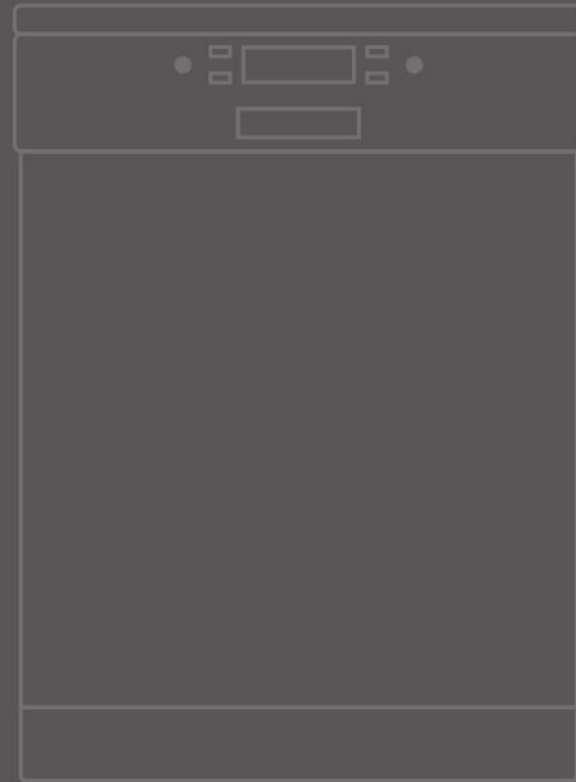

DISHWASHER

1 Triple stage drying, clean and sterilized.

2 3D washing, allow it to easily wash all kinds of oily tableware.

3 Low noise and energy saving for a clean life.

4 Triple effective filtration filters, easy clean and disassemble.

5 BLDC variable frequency motor.



WQP15-W651B/S



Product Size:	598x845x598mm (WxHxD)
Rated Power Input:	1900W
Energy Star Rating:	★★★★
Water Star Rating:	★★★★★
Noise Level:	42dB(A)

Features

- 14min quick wash;
- Triple drying system, clean and remove bacteria;
- BLDC inverter motor
- 42dB Quiet washing;
- 15 Settings big capacity;
- 8 Washing modes;

Certificate

RCM

Installation

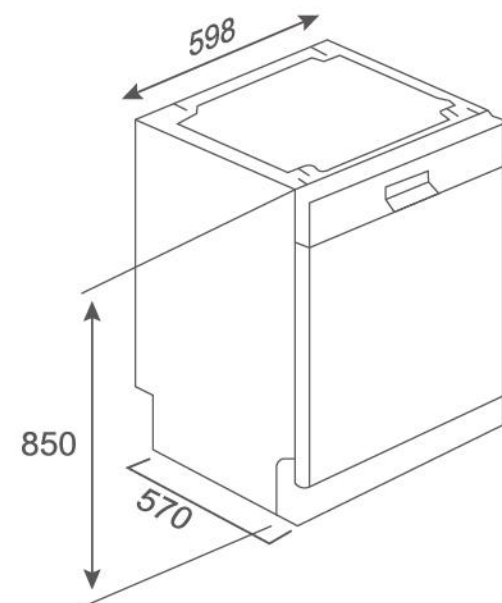

WQP12-W602S/W



Product Size:	598x845x600mm (WxHxD)
Power Rating:	1760-2100W
Energy Star Rating:	★★★
Water Star Rating:	★★★★☆
Capacity:	12 Place settings
Noise Level:	49dB(A)

Features

- 3D Washing and drying system;
- Triple filtering system;
- 6 Washing modes;
- 12 Settings capacity;

Certificate

RCM / SIRIM

Installation

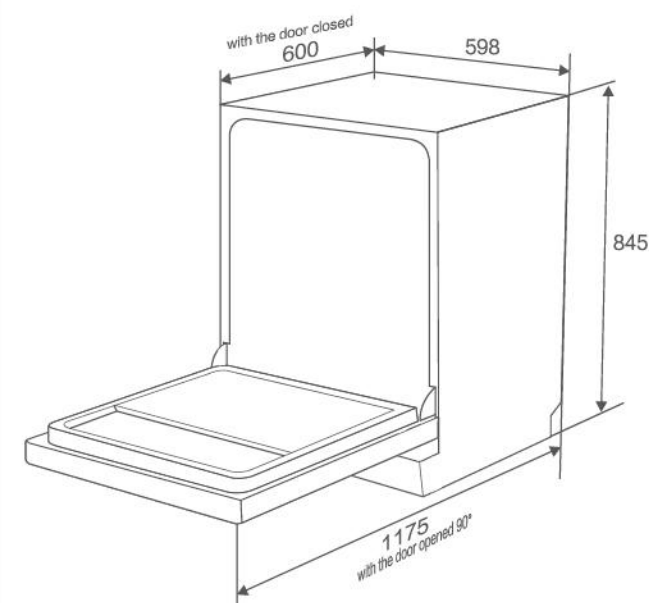

WQP14-W652S

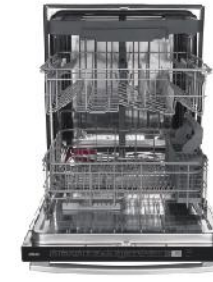

Product Size:	23.9x33.7x24.5"(WxHxD)
Capacity:	14 Place settings
Power Rating:	1900W
Current :	8.4(A)
Energy Consumption:	★★★★★

*SPECIALLY FOR NORTH AMERICAN KITCHENS 🇺🇸 🇨🇦 🇩🇪

Features

- Vortex strong washing;
- 6+7 Intelligent washing programs (6 modes+ 7 functions);
- Whole-course sterilization;
- Triple drying;
- 6-hour automatic ventilation;
- 14 Settings capacity;

Certificate

cETLus / IC / FCC / DOE

Installation

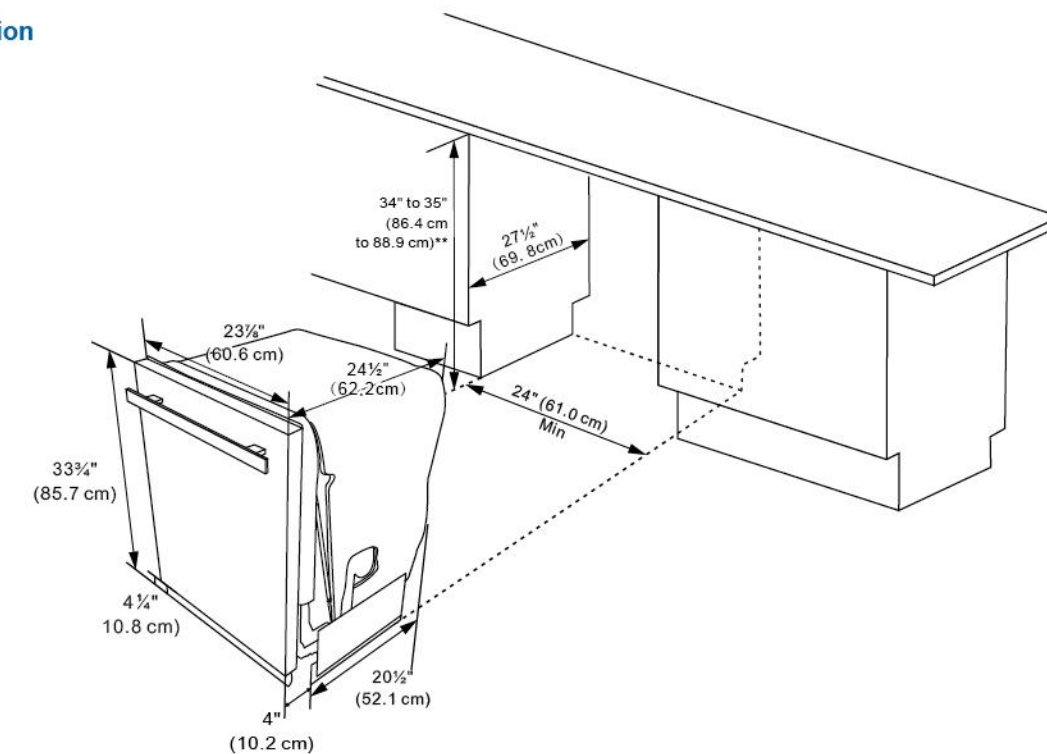

产品综合目录

部分印刷工艺说明及效果

ROBAM

2021

PRODUCT CATALOG

ROBAM

工艺: UV

外封面
工艺: 烫银

内封面
工艺：压凹

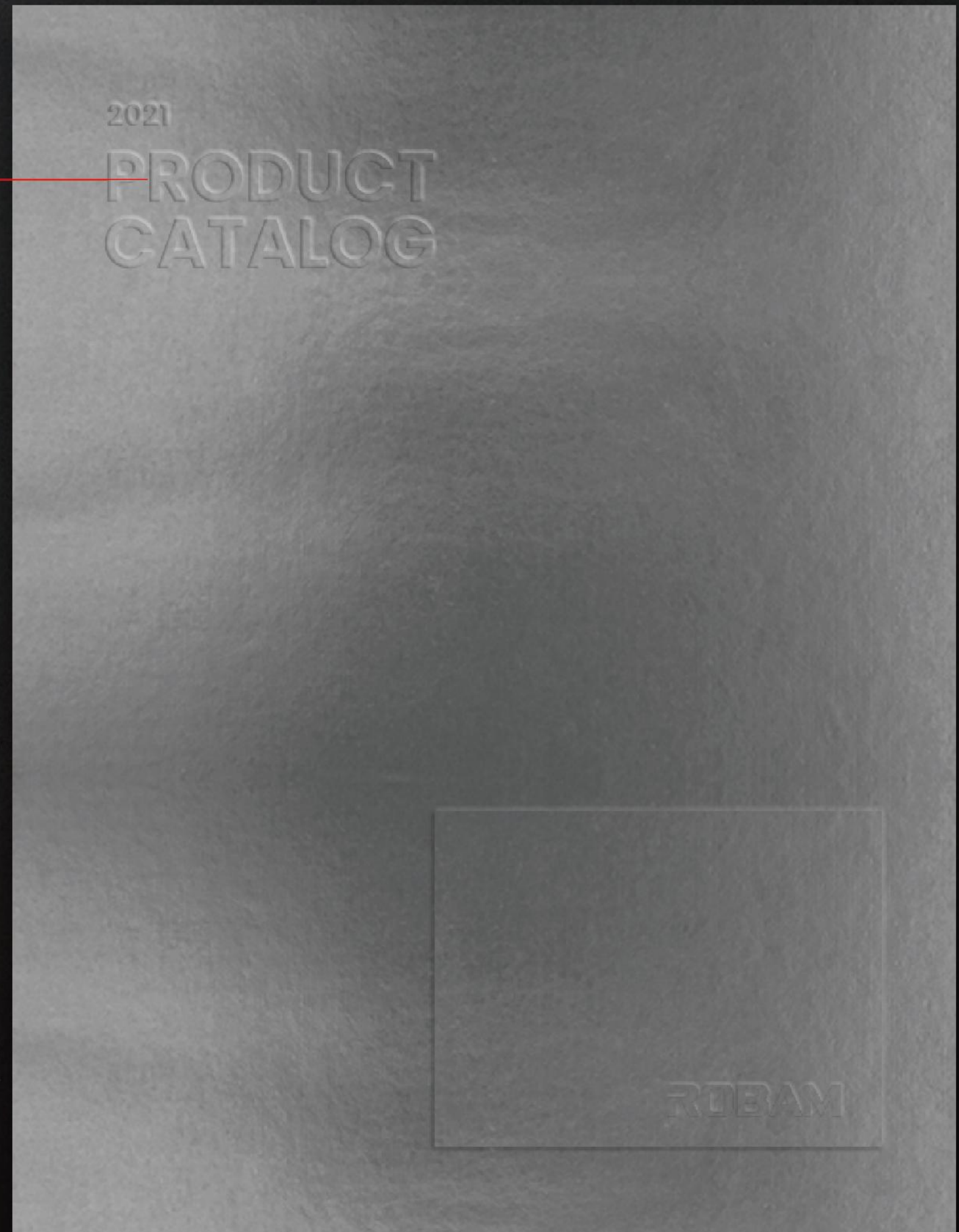

2021

PRODUCT
CATALOG

ROBAM

2021
PRODUCT
CATALOG

ROBAM
WORLD CLASS LEADER
OF PREMIUM KITCHEN
APPLIANCES

SINCE 1979



THE OVERSEAS LAYOUT

At present, ROBAM has dozens of brand shops and more than 400 retail terminals overseas.



地图工艺：
烫透明UV或透明箔

Whether in American, Canada, Australia, New Zealand, Malaysia, India, Pakistan, Myanmar, Dubai, Vietnam or other countries in the five continents, ROBAM has emerged as a high-end appliance representative and gets trust from more and more overseas consumers.

